

KEG CAPACITY OF STANDARD 2 DOOR CABINETS  
(2 HALF BARRELS, 1 SLIM QUARTER BARREL)

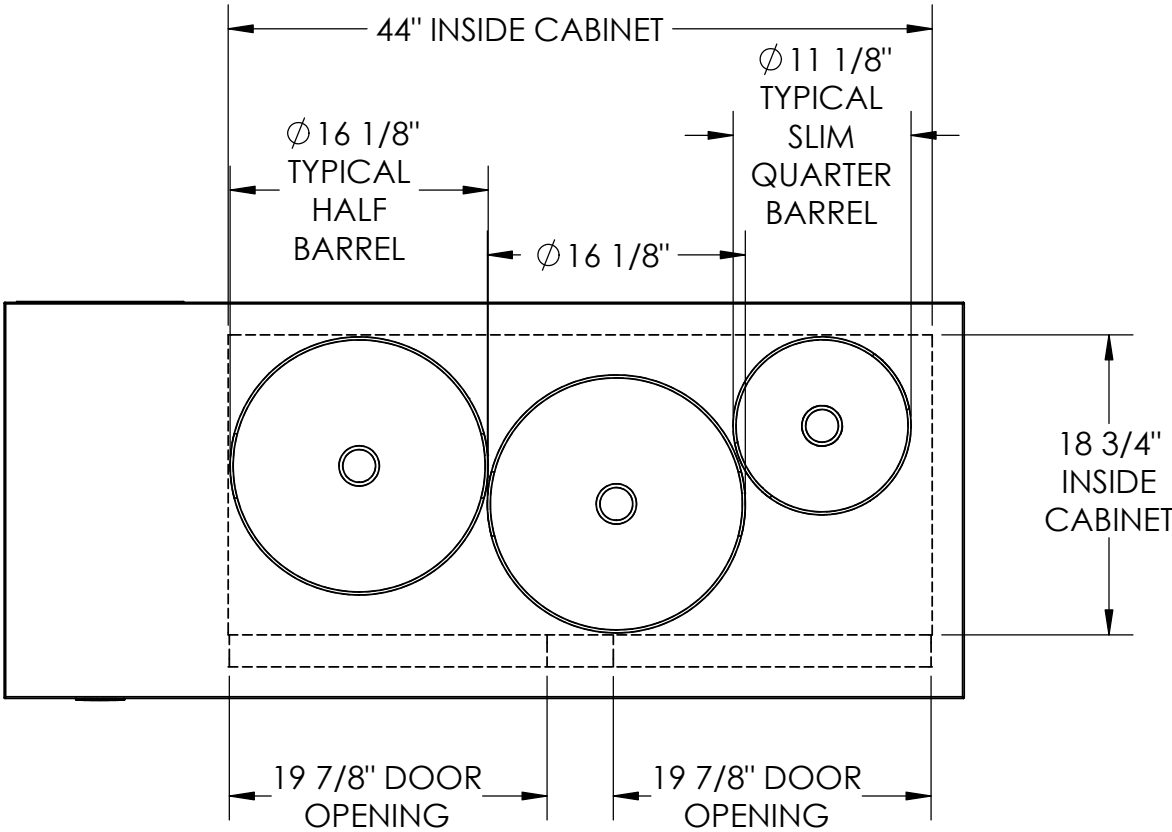

- NOTES:
- 1. KEG CAPACITY DIAGRAM IS SHOWN FOR MAXIMUM CABINET SPACE ONLY. CUSTOMER TO DETERMINE OPTIMUM PLACEMENT OF DIFFERENT KEG SIZES.
  - 2. KEG TO KEG SPACING & KEG TO WALL SPACING IS SHOWN AT 1/8".
  - 3. REFERENCE ASSEMBLY NUMBER IS: BBS60

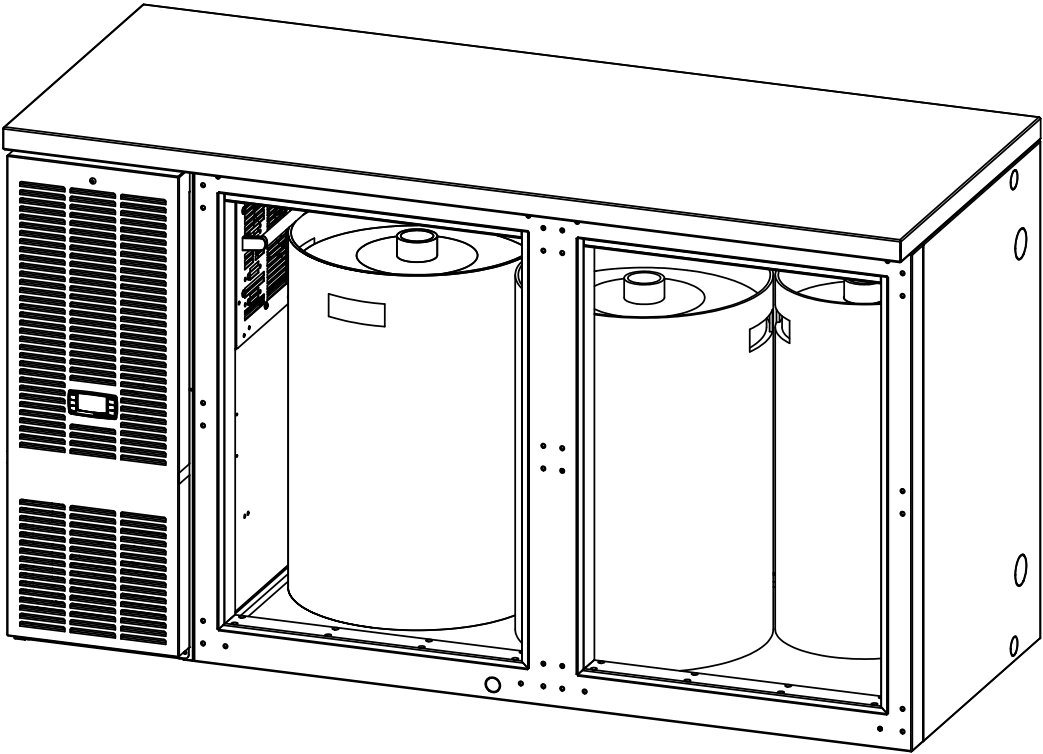

PERLICK CORPORATION  
MILWAUKEE, WI 53223

PROPERTY OF THE PERLICK CORP.  
NOT TO BE COPIED OR USED DETRIMENTAL TO OUR INTERESTS

SCALE: 1:12  
DR.: TJZ DATE: 05/28/13

PRINTED  
5/29/2013

95143  
SHEET 1 OF 5

**KEG CAPACITY OF STANDARD 2 DOOR CABINETS  
(1 HALF BARREL, 3 SLIM QUARTER BARRELS)**

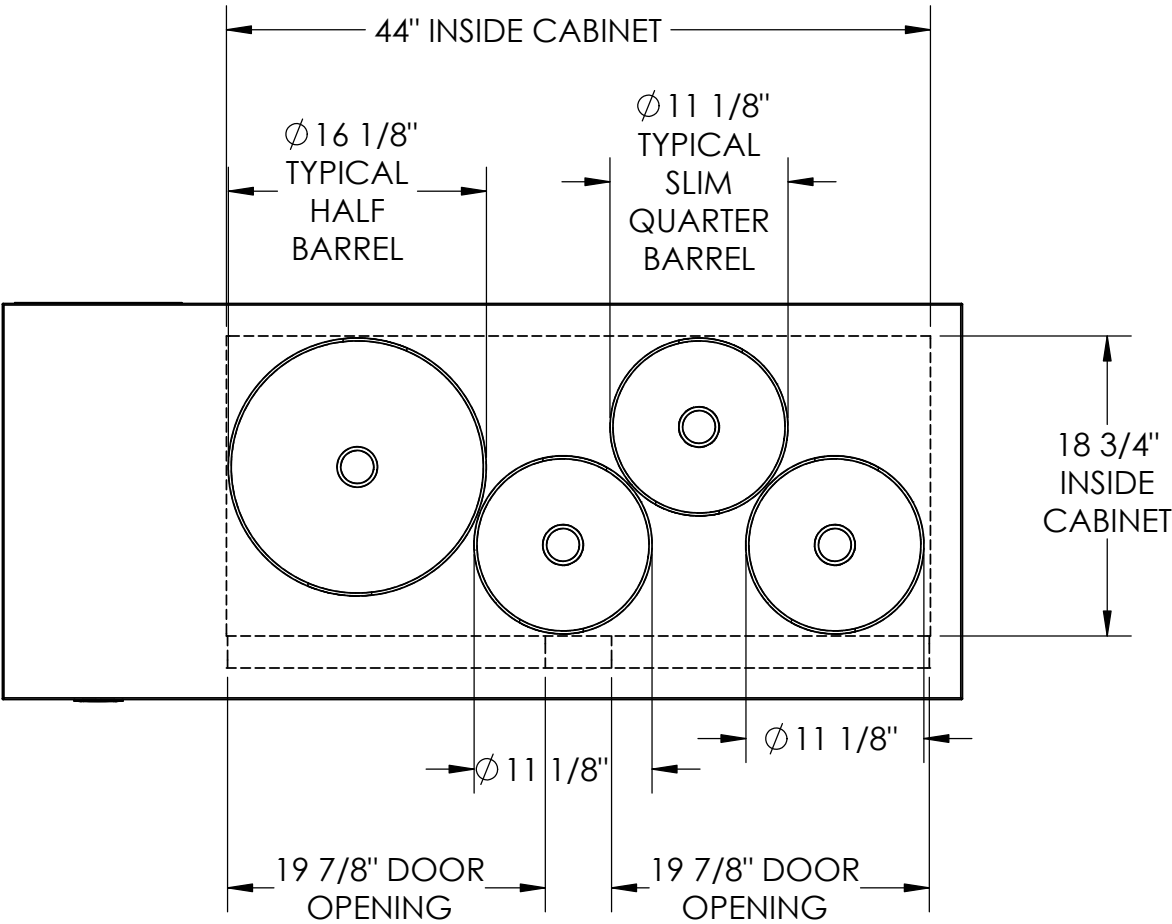
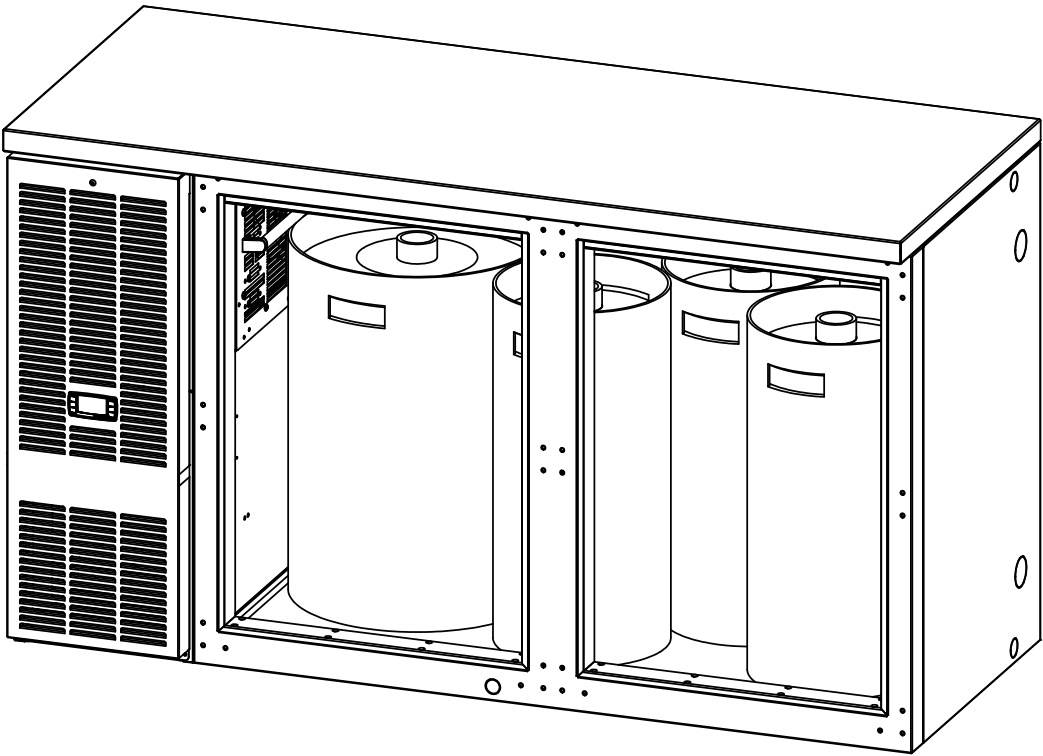

- NOTES:
- 1. KEG CAPACITY DIAGRAM IS SHOWN FOR MAXIMUM CABINET SPACE ONLY. CUSTOMER TO DETERMINE OPTIMUM PLACEMENT OF DIFFERENT KEG SIZES.
  - 2. KEG TO KEG SPACING & KEG TO WALL SPACING IS SHOWN AT  $\frac{1}{8}"$ .
  - 3. REFERENCE ASSEMBLY NUMBER IS: BBS60



PERLICK CORPORATION  
MILWAUKEE, WI 53223

PROPERTY OF THE PERLICK CORP.  
NOT TO BE COPIED OR USED DETRIMENTAL TO OUR INTERESTS

SCALE: 1:12  
DR.: TJZ DATE: 05/28/13

PRINTED  
5/29/2013

**95143**  
SHEET 2 OF 5

KEG CAPACITY OF STANDARD 2 DOOR CABINETS  
( 4 SLIM QUARTER BARRELS, 1 SIXTH BARREL)

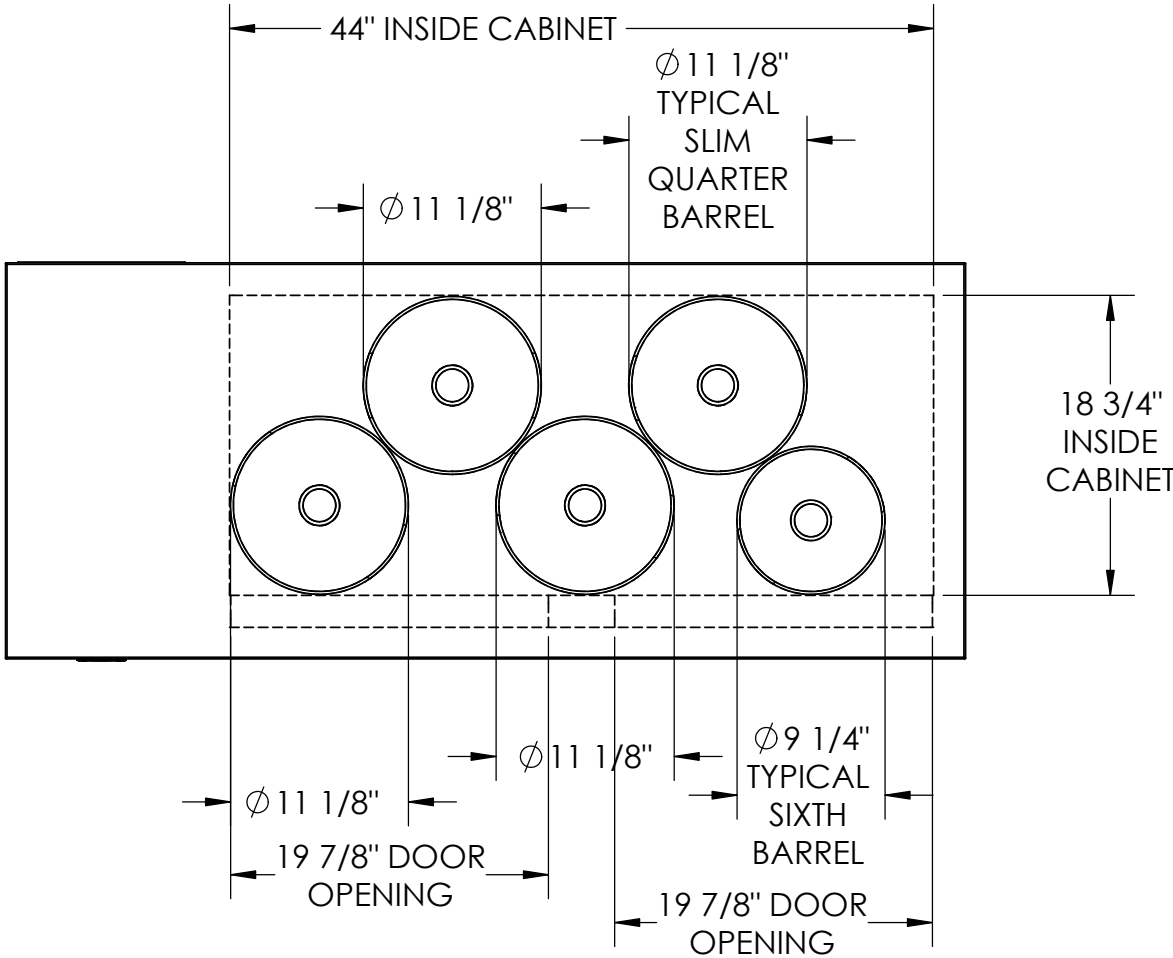
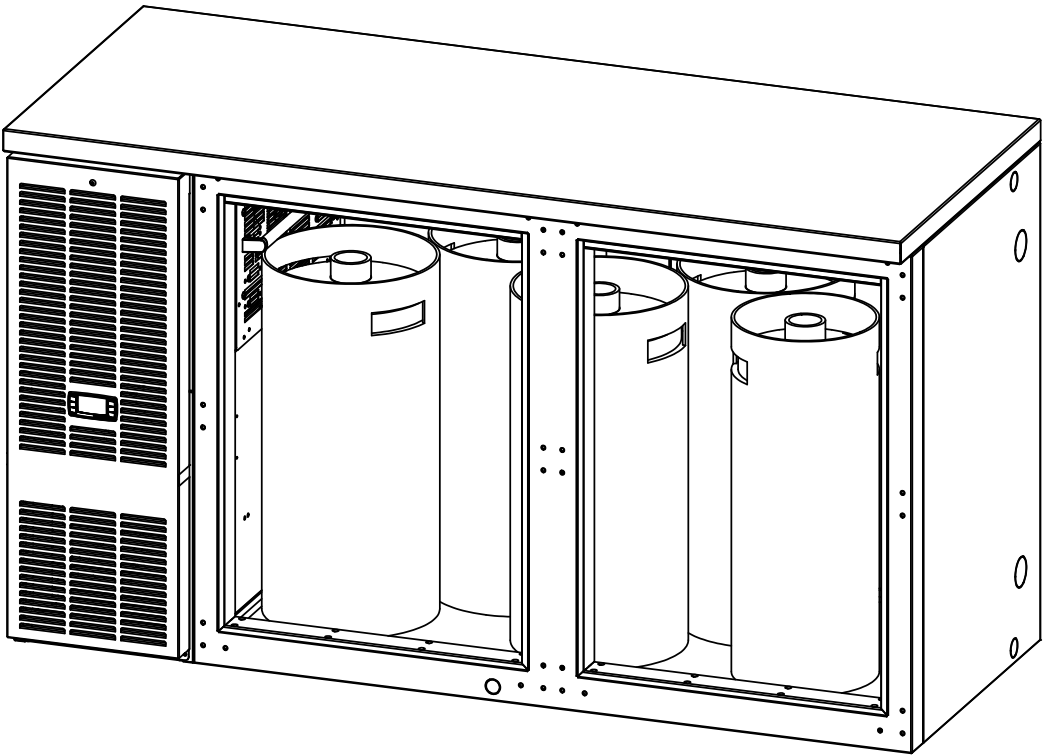

- NOTES:
- 1. KEG CAPACITY DIAGRAM IS SHOWN FOR MAXIMUM CABINET SPACE ONLY. CUSTOMER TO DETERMINE OPTIMUM PLACEMENT OF DIFFERENT KEG SIZES.
  - 2. KEG TO KEG SPACING & KEG TO WALL SPACING IS SHOWN AT 1/16".
  - 3. REFERENCE ASSEMBLY NUMBER IS: BBS60



PERLICK CORPORATION  
MILWAUKEE, WI 53223

PROPERTY OF THE PERLICK CORP.  
NOT TO BE COPIED OR USED DETRIMENTAL TO OUR INTERESTS

PRINTED  
5/29/2013

SCALE:	1:12
DR.: TJZ	DATE: 05/28/13
95143	
SHEET 3 OF 5	

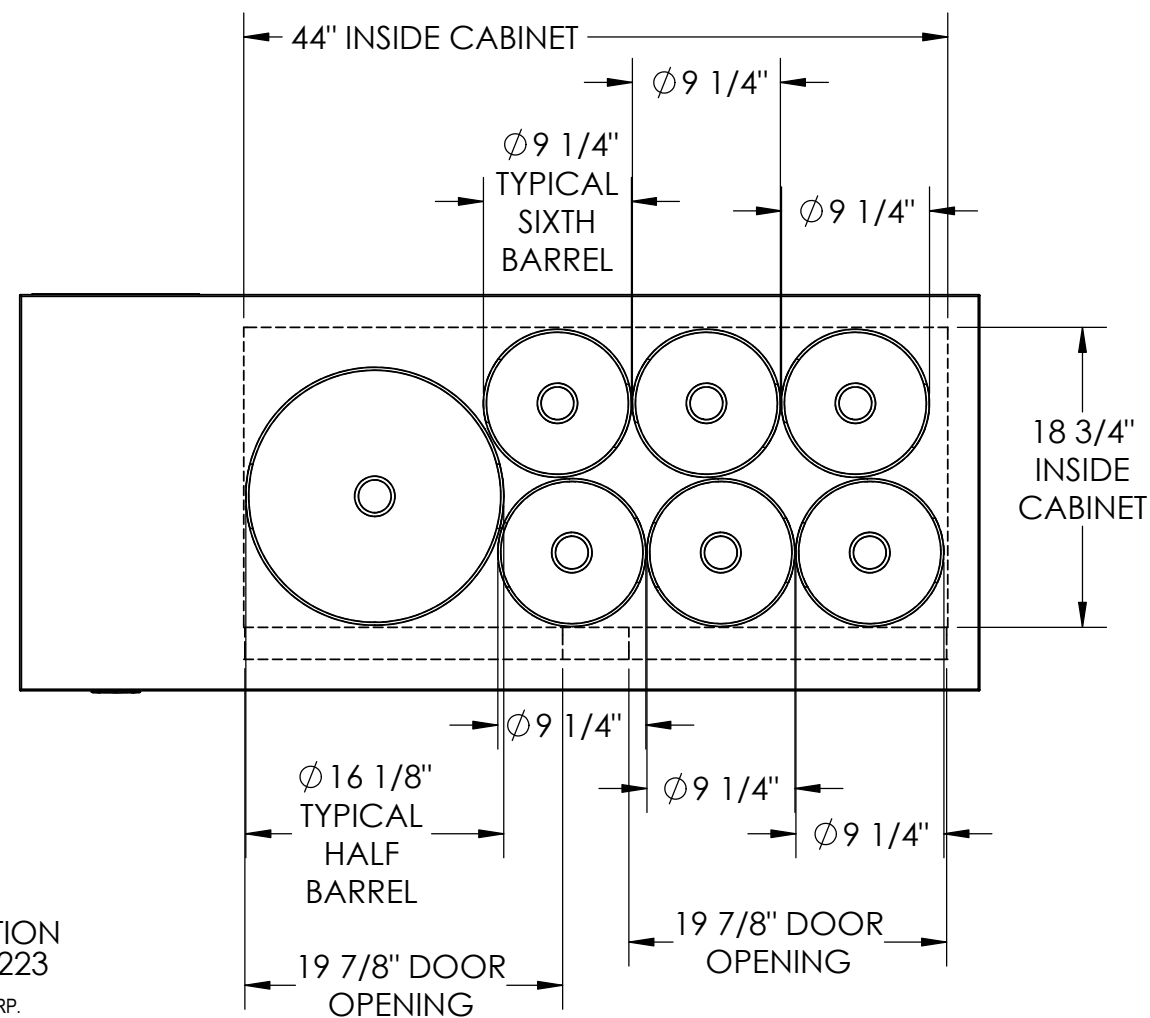

1. KEG CAPACITY DIAGRAM IS SHOWN FOR MAXIMUM CABINET SPACE ONLY. CUSTOMER TO DETERMINE OPTIMUM PLACEMENT OF DIFFERENT KEG SIZES.
2. KEG TO KEG SPACING & KEG TO WALL SPACING IS SHOWN AT 1/8".
3. REFERENCE ASSEMBLY NUMBER IS: BBS60



PROPERTY OF THE PERLICK CORP.  
NOT TO BE COPIED OR USED DETRIMENTAL TO OUR INTERESTS

**95143**

SHEET 4 OF 5

PRINTED  
5/29/2013

KEG CAPACITY OF STANDARD 2 DOOR CABINETS  
( 8 SIXTH BARRELS)

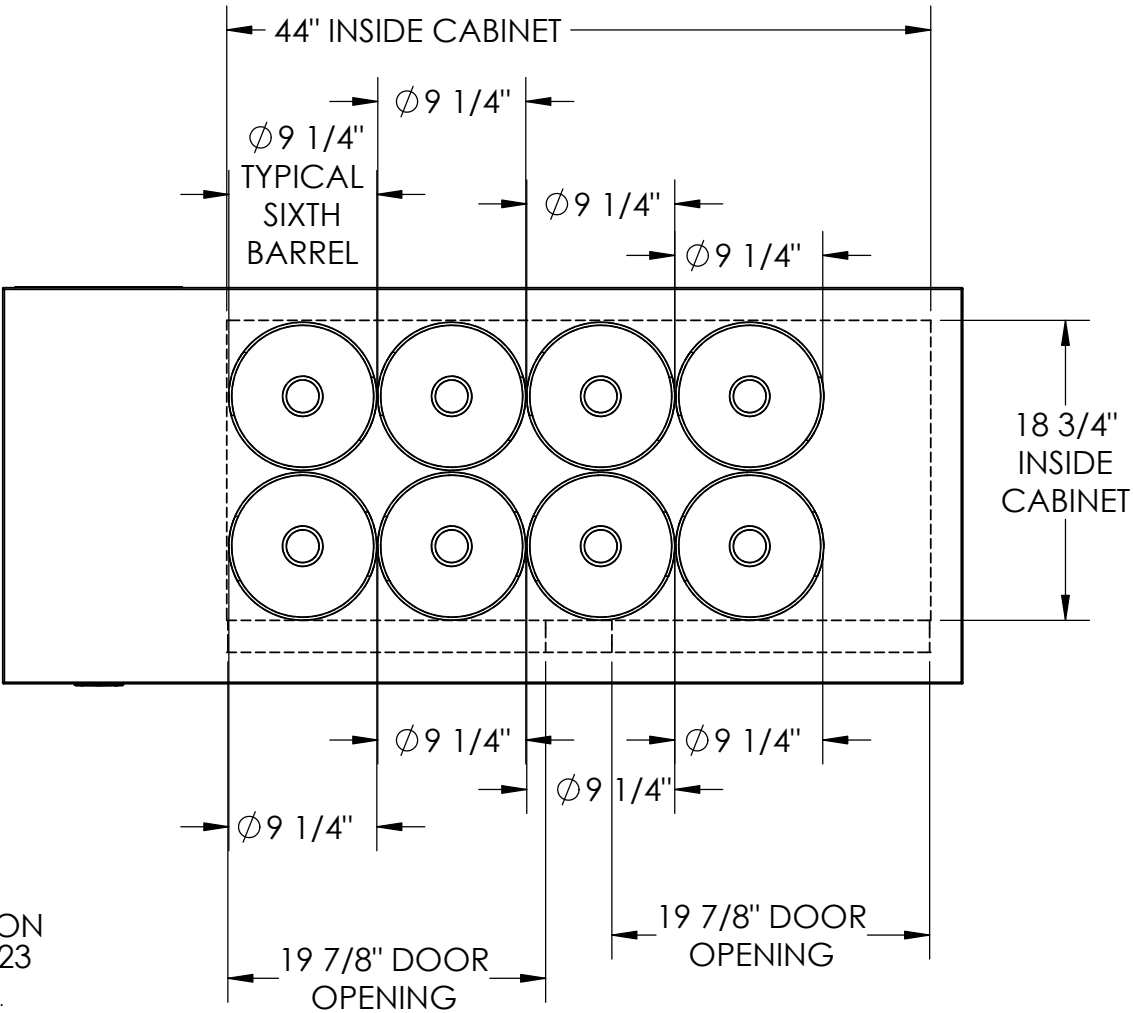
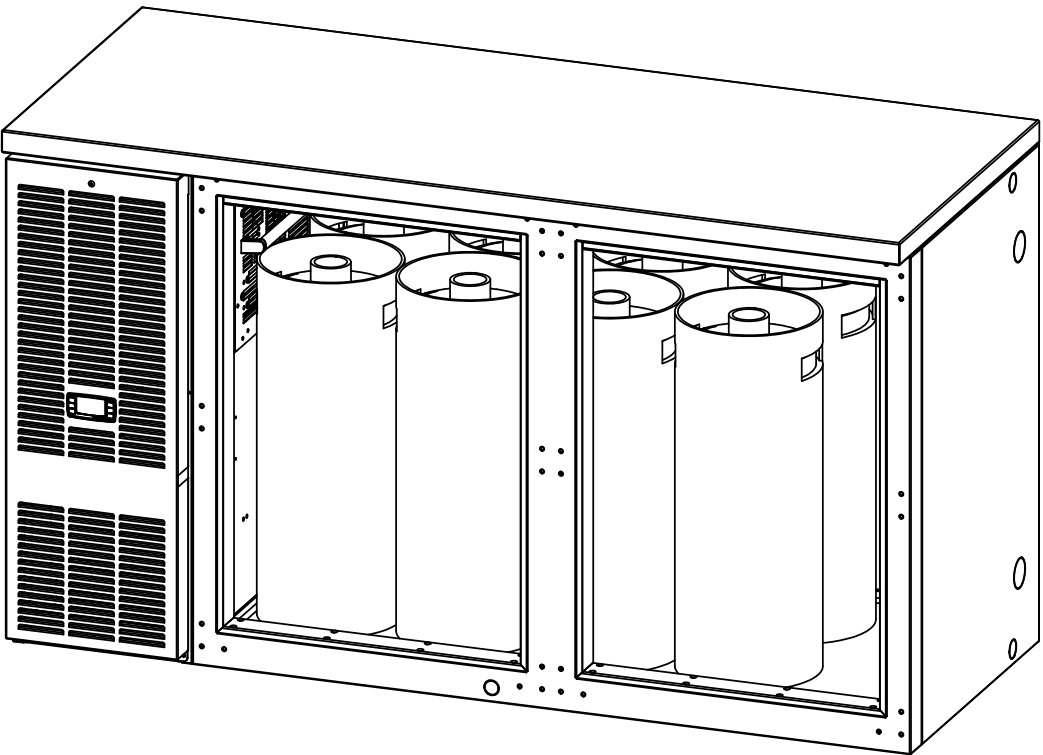

- NOTES:
- 1. KEG CAPACITY DIAGRAM IS SHOWN FOR MAXIMUM CABINET SPACE ONLY. CUSTOMER TO DETERMINE OPTIMUM PLACEMENT OF DIFFERENT KEG SIZES.
  - 2. KEG TO KEG SPACING & KEG TO WALL SPACING IS SHOWN AT 1/8".
  - 3. REFERENCE ASSEMBLY NUMBER IS: BBS60



PERLICK CORPORATION  
MILWAUKEE, WI 53223

PROPERTY OF THE PERLICK CORP.  
NOT TO BE COPIED OR USED DETRIMENTAL TO OUR INTERESTS

SCALE:	1:12
DR.: TJZ	DATE: 05/28/13
95143	
SHEET 5 OF 5	

PRINTED  
5/29/2013