

# KEG CAPACITY OF STANDARD 4 DOOR CABINETS (5 HALF BARRELS, 1 SLIM QUARTER BARREL)

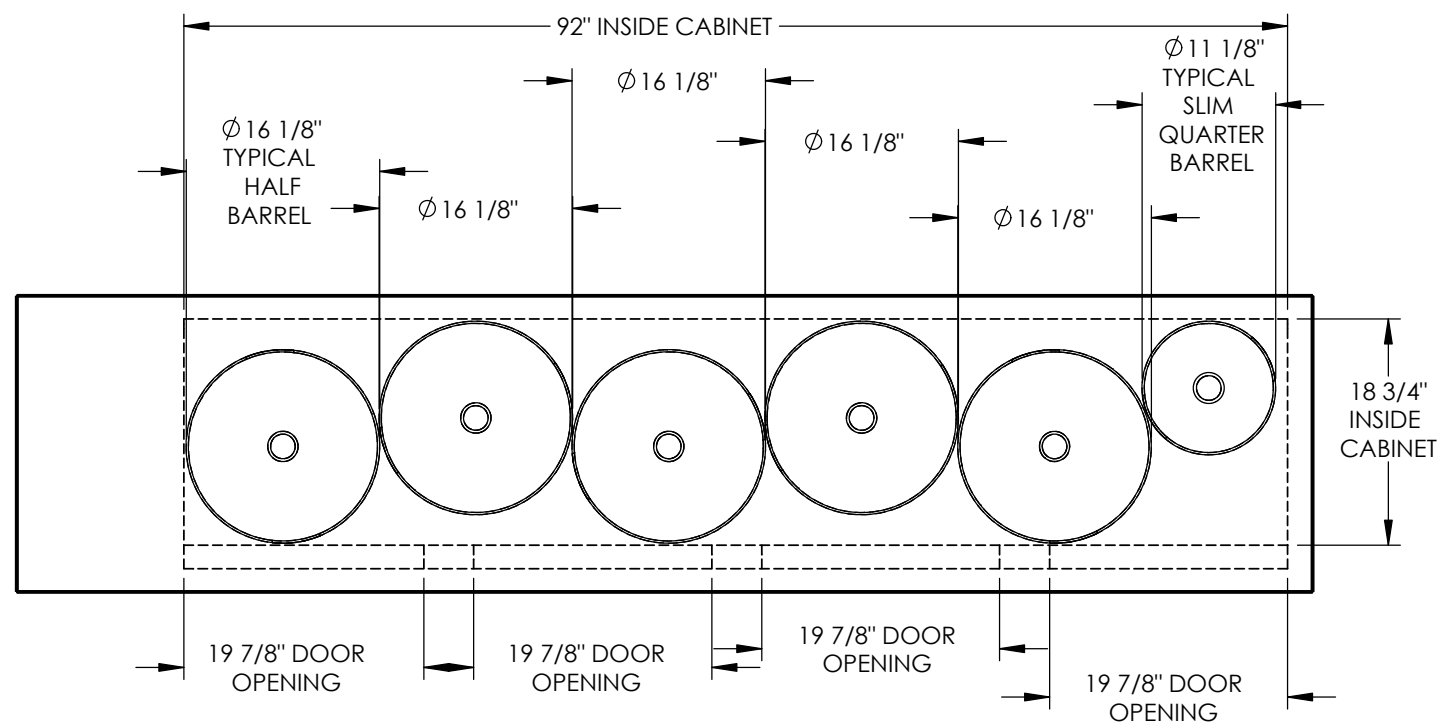

- NOTES:
- 1. KEG CAPACITY DIAGRAM IS SHOW FOR MAXIMUM CABINET SPACE ONLY. CUSTOMER TO DETERMINE OPTIMUM PLACEMENT OF DIFFERENT KEG SIZES.
  - 2. 1/8" SPACING WAS USED BETWEEN KEGS AND INSIDE CABINET FOR KEG DIA TOLERACE AND FIT UP.
  - 3. REFERENCE ASSEMBLY # IS: BBS108

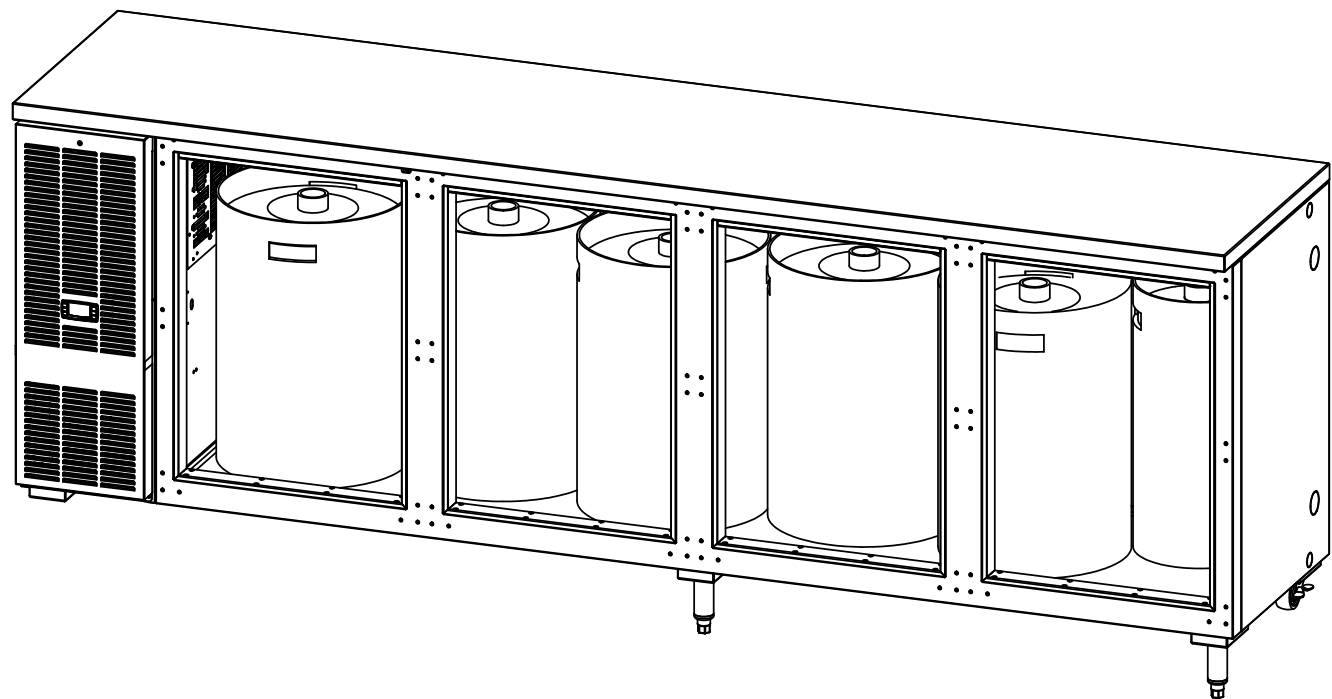

PERLICK CORPORATION  
MILWAUKEE, WI 53223

PROPERTY OF THE PERLICK CORP.  
NOT TO BE COPIED OR USED DETRIMENTAL TO OUR INTERESTS

SCALE:	1:16
DR.: TJZ	DATE: 5/14/13
95145	
SHEET 1 OF 12	

PRINTED  
5/22/2013

# KEG CAPACITY OF STANDARD 4 DOOR CABINETS (4 HALF BARRELS, 3 SLIM QUARTER BARRELS)

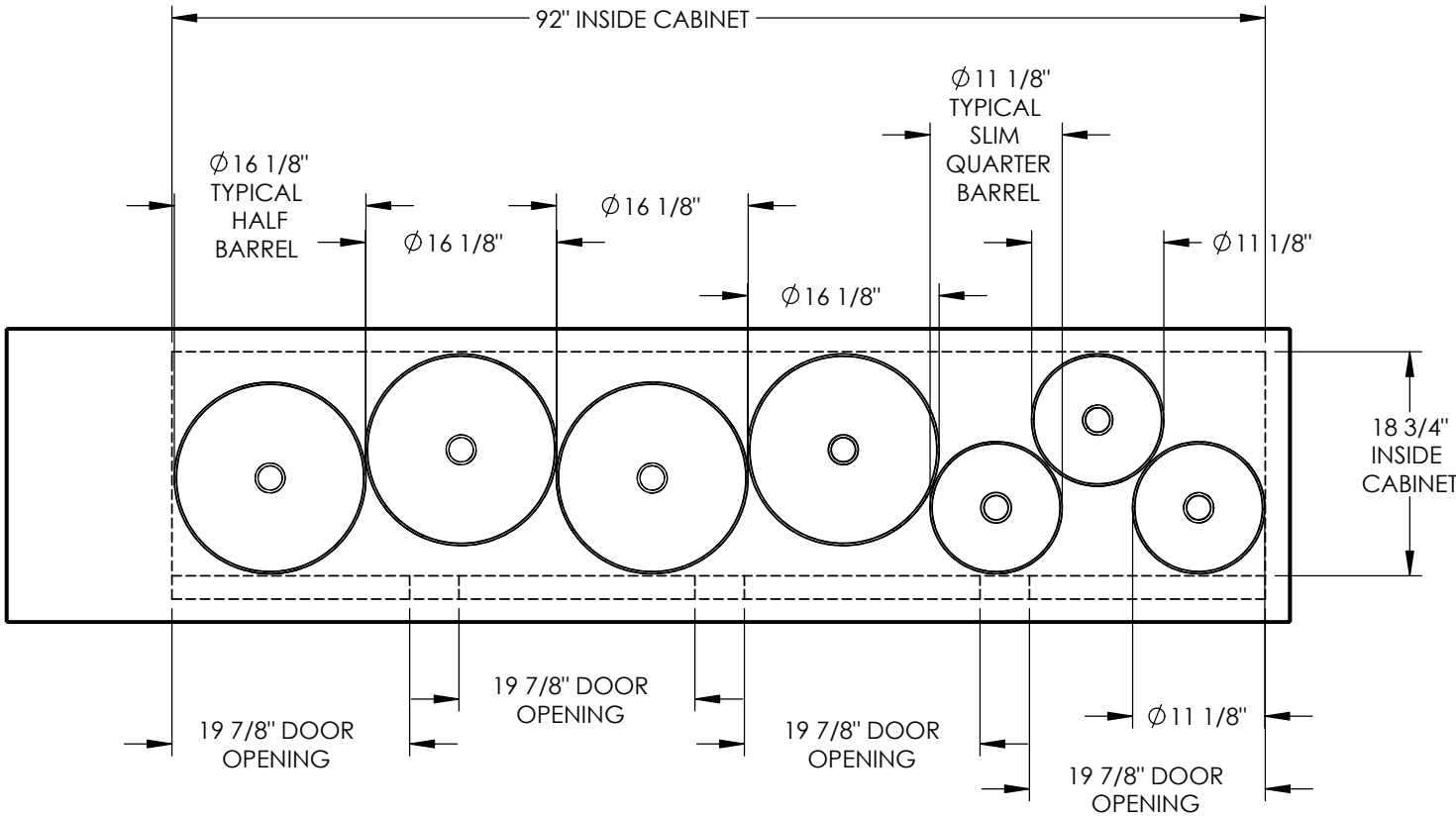
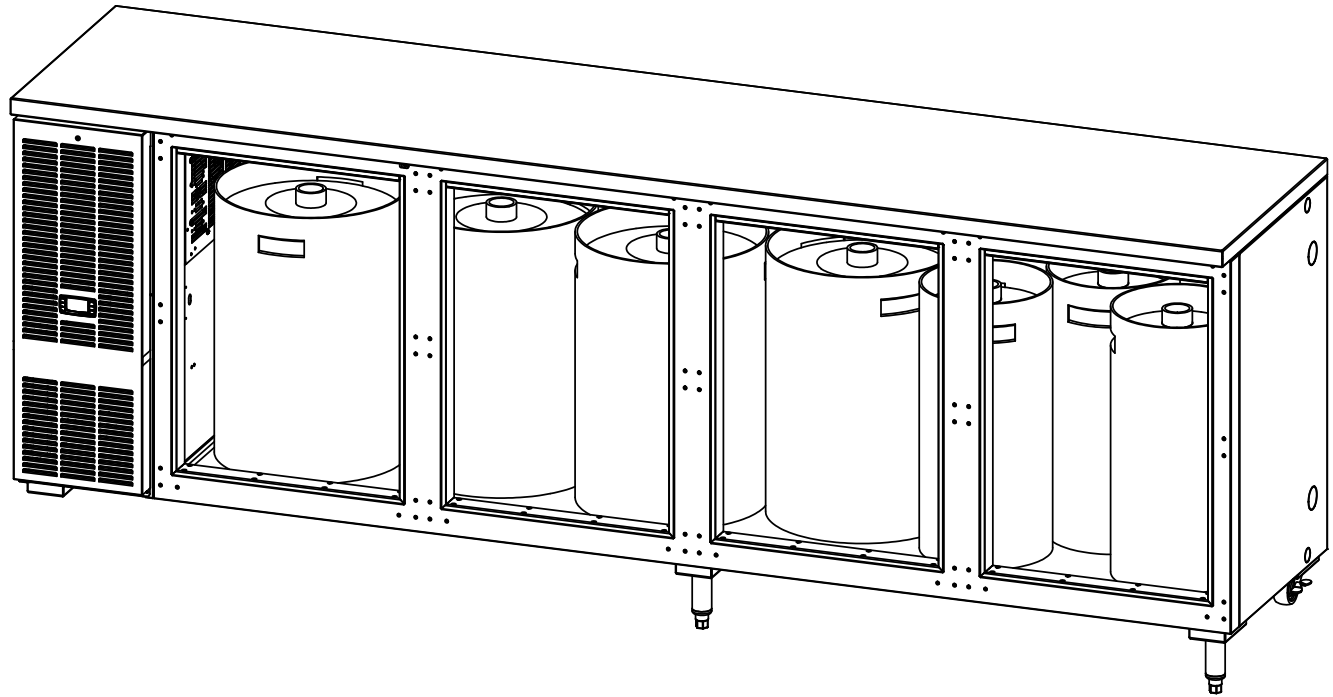

- NOTES:
- 1. KEG CAPACITY DIAGRAM IS SHOW FOR MAXIMUM CABINET SPACE ONLY. CUSTOMER TO DETERMINE OPTIMUM PLACEMENT OF DIFFERENT KEG SIZES.
  - 2. 1/8" SPACING WAS USED BETWEEN KEGS AND INSIDE CABINET FOR KEG DIA TOLERENCE AND FIT UP.
  - 3. REFERENCE ASSEMBLY # IS: BBS108



PERLICK CORPORATION  
MILWAUKEE, WI 53223

PROPERTY OF THE PERLICK CORP.  
NOT TO BE COPIED OR USED DETRIMENTAL TO OUR INTERESTS

SCALE: 1:16	
DR.: TJZ	DATE: 5/14/13
95145	
SHEET 2 OF 12	

PRINTED  
5/22/2013

# KEG CAPACITY OF STANDARD 4 DOOR CABINETS (3 HALF BARRELS, 5 SLIM QUARTER BARRELS)

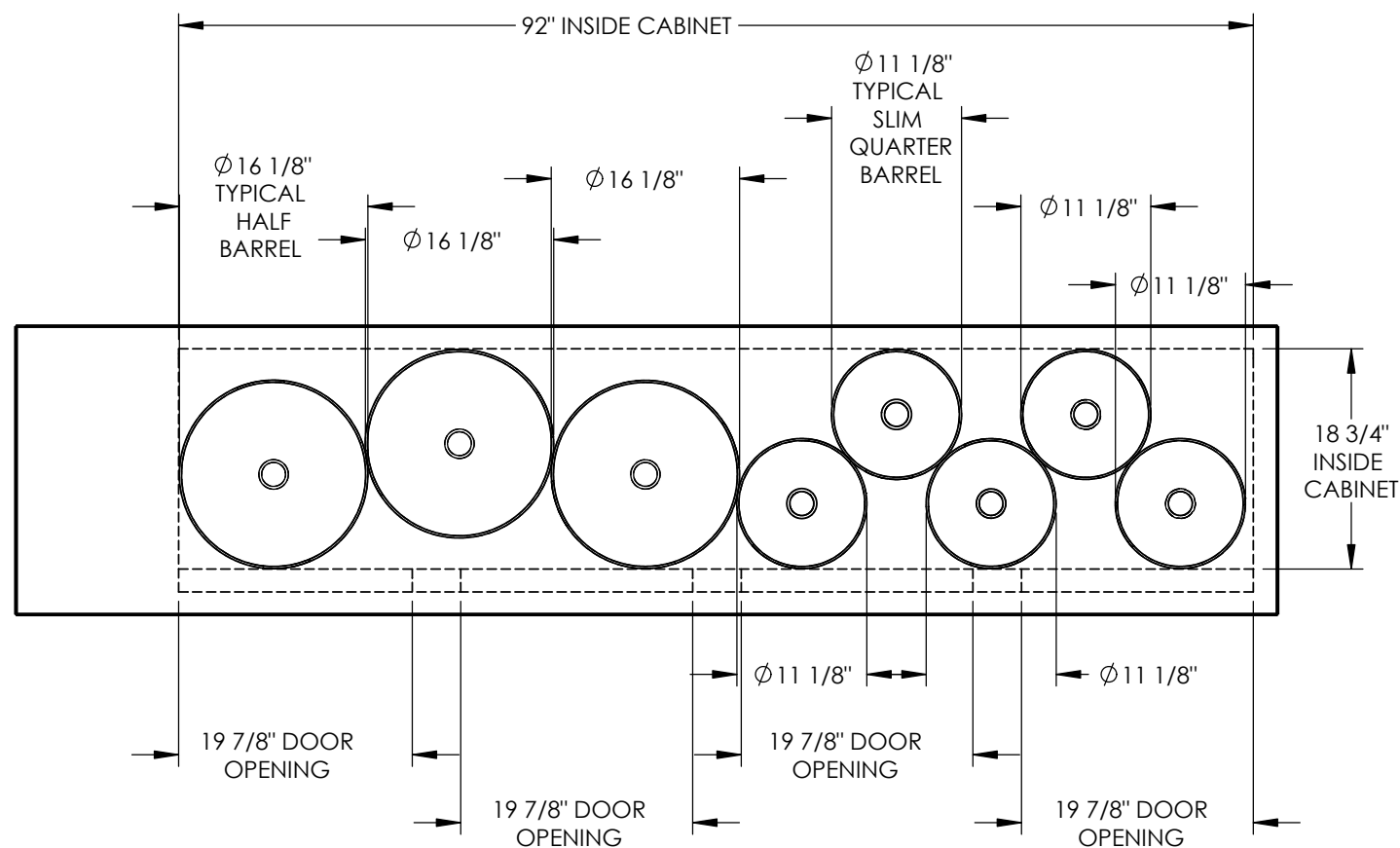
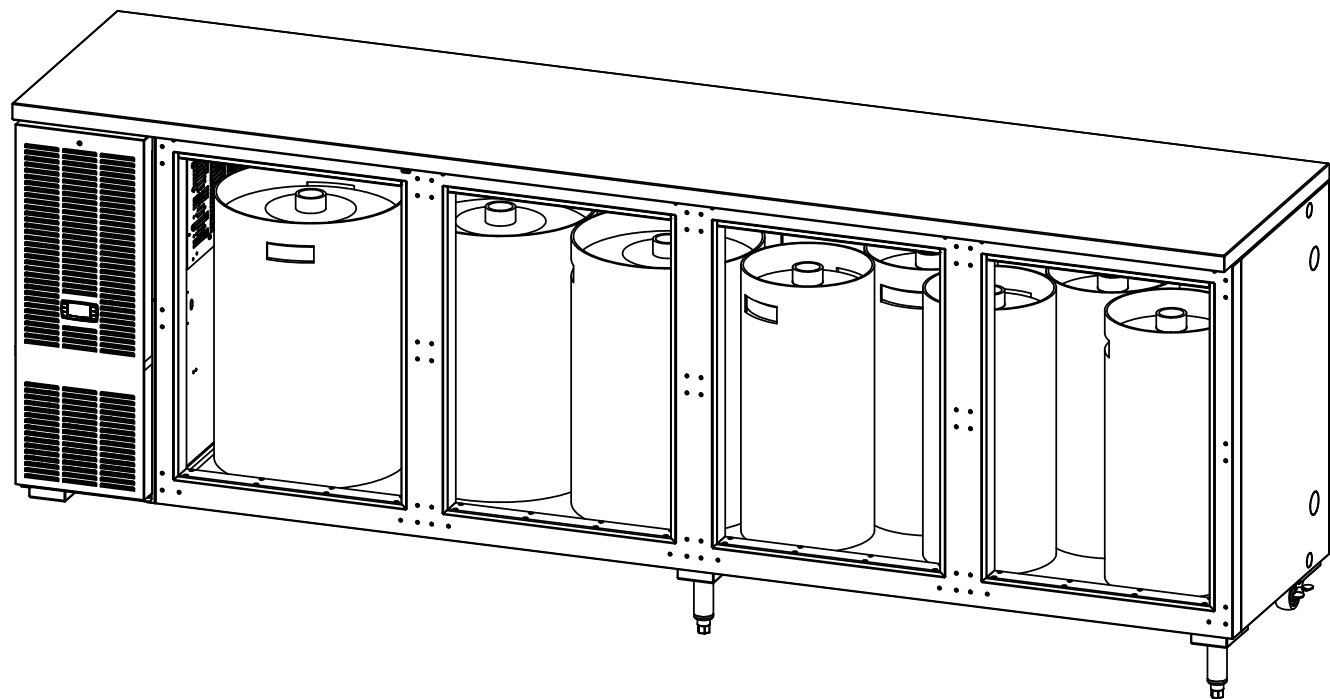

- NOTES:
1. KEG CAPACITY DIAGRAM IS SHOW FOR MAXIMUM CABINET SPACE ONLY. CUSTOMER TO DETERMINE OPTIMUM PLACEMENT OF DIFFERENT KEG SIZES.
  2.  $\frac{1}{8}"$  SPACING WAS USED BETWEEN KEYS AND INSIDE CABINET FOR KEG DIA TOLERACE AND FIT UP.
  3. REFERENCE ASSEMBLY # IS: BBS108

# KEG CAPACITY OF STANDARD 4 DOOR CABINETS (2 HALF BARRELS, 7 SLIM QUARTER BARRELS)

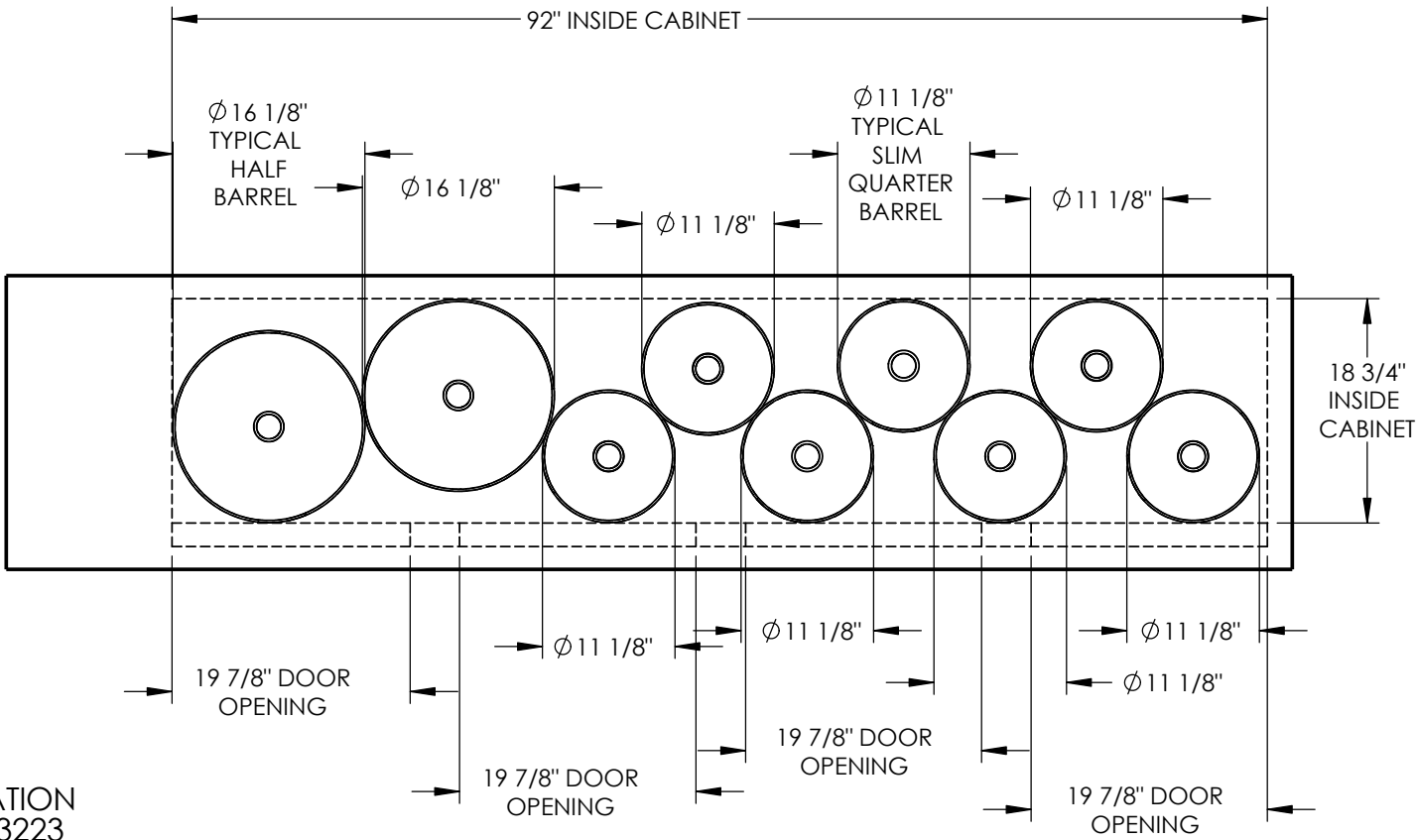
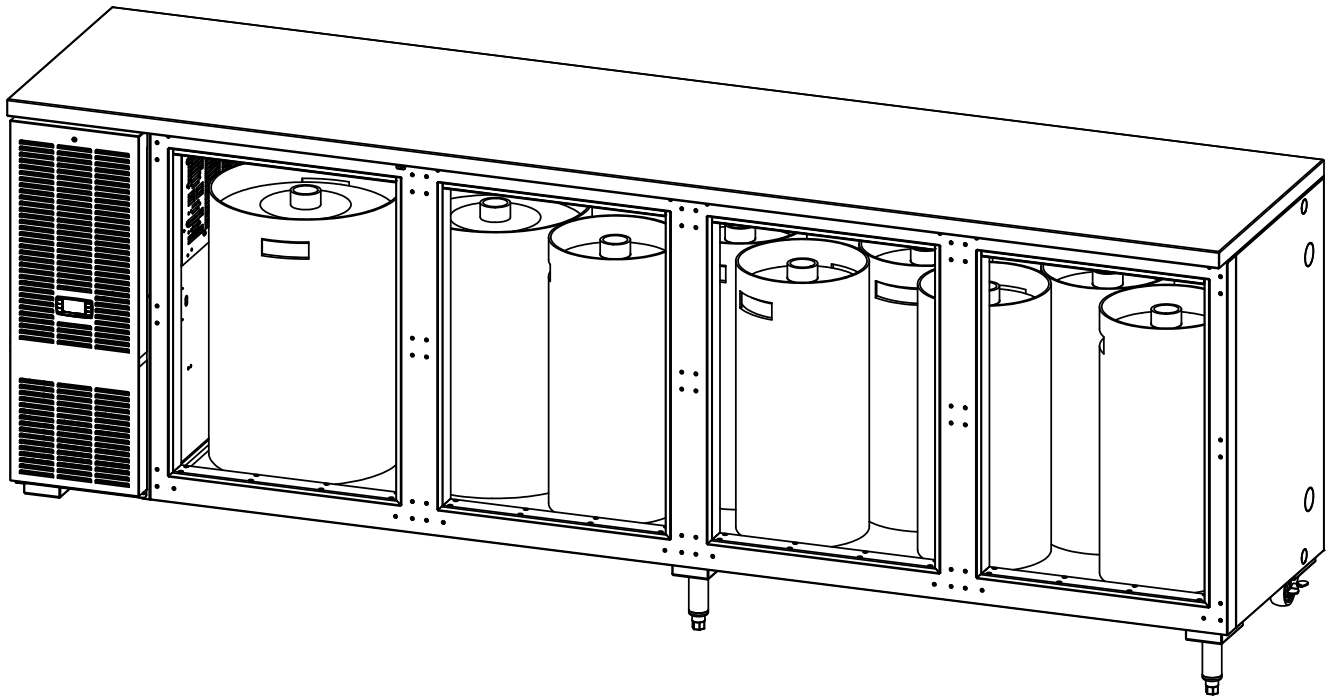

- NOTES:
1. KEG CAPACITY DIAGRAM IS SHOW FOR MAXIMUM CABINET SPACE ONLY. CUSTOMER TO DETERMINE OPTIMUM PLACEMENT OF DIFFERENT KEG SIZES.
  2. 1/8" SPACING WAS USED BETWEEN KEGS AND INSIDE CABINET FOR KEG DIA TOLERACE AND FIT UP.
  3. REFERENCE ASSEMBLY # IS: BBS108



PERLICK CORPORATION  
MILWAUKEE, WI 53223

PROPERTY OF THE PERLICK CORP.  
NOT TO BE COPIED OR USED DETRIMENTAL TO OUR INTERESTS

SCALE:	1:16
DR.: <b>TJZ</b>	DATE: <b>5/14/13</b>
<b>95145</b>	
SHEET 4 OF 12	

PRINTED  
5/22/2013

KEG CAPACITY OF STANDARD 4 DOOR CABINETS  
(10 SLIM QUARTER BARRELS)

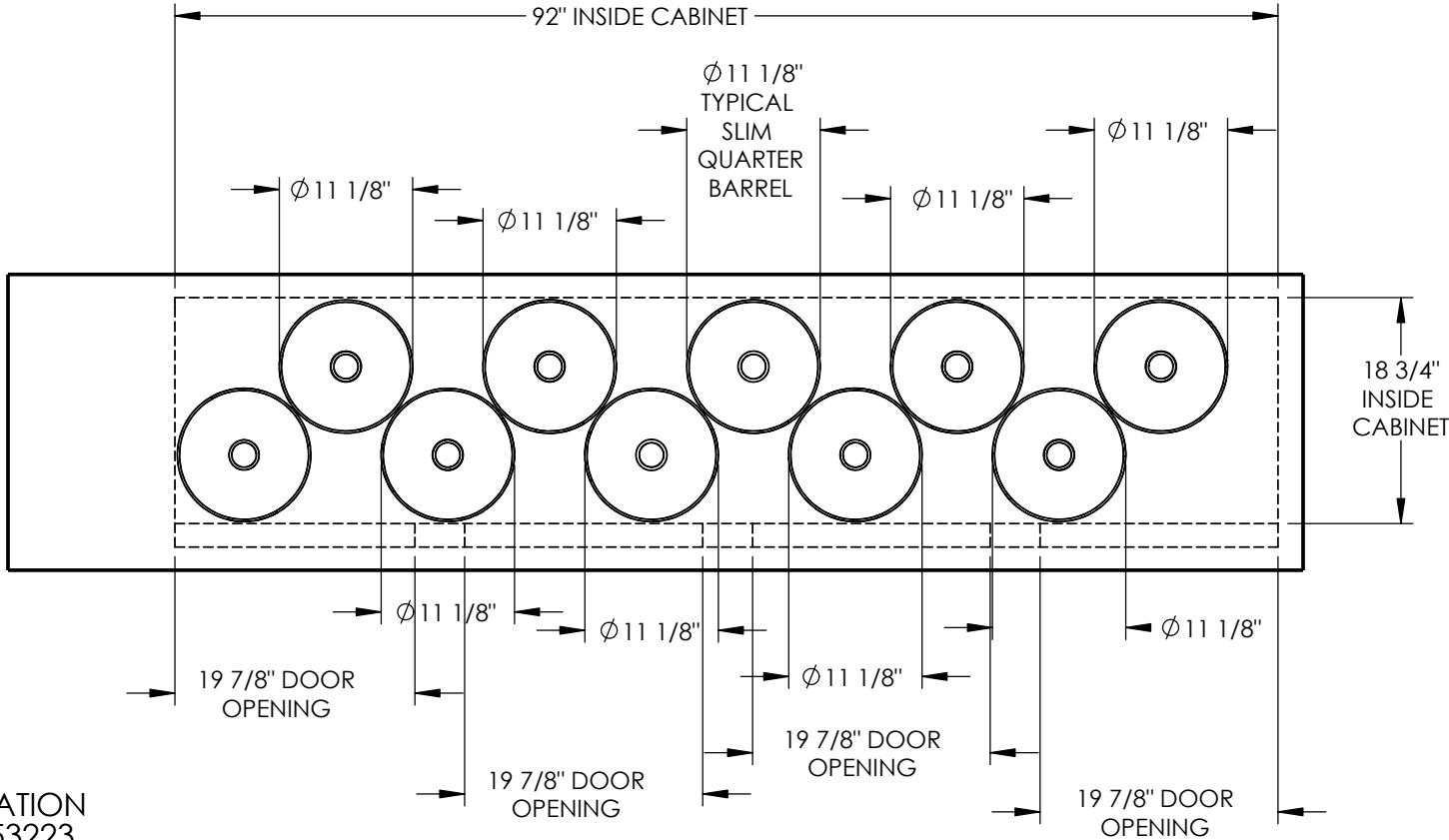
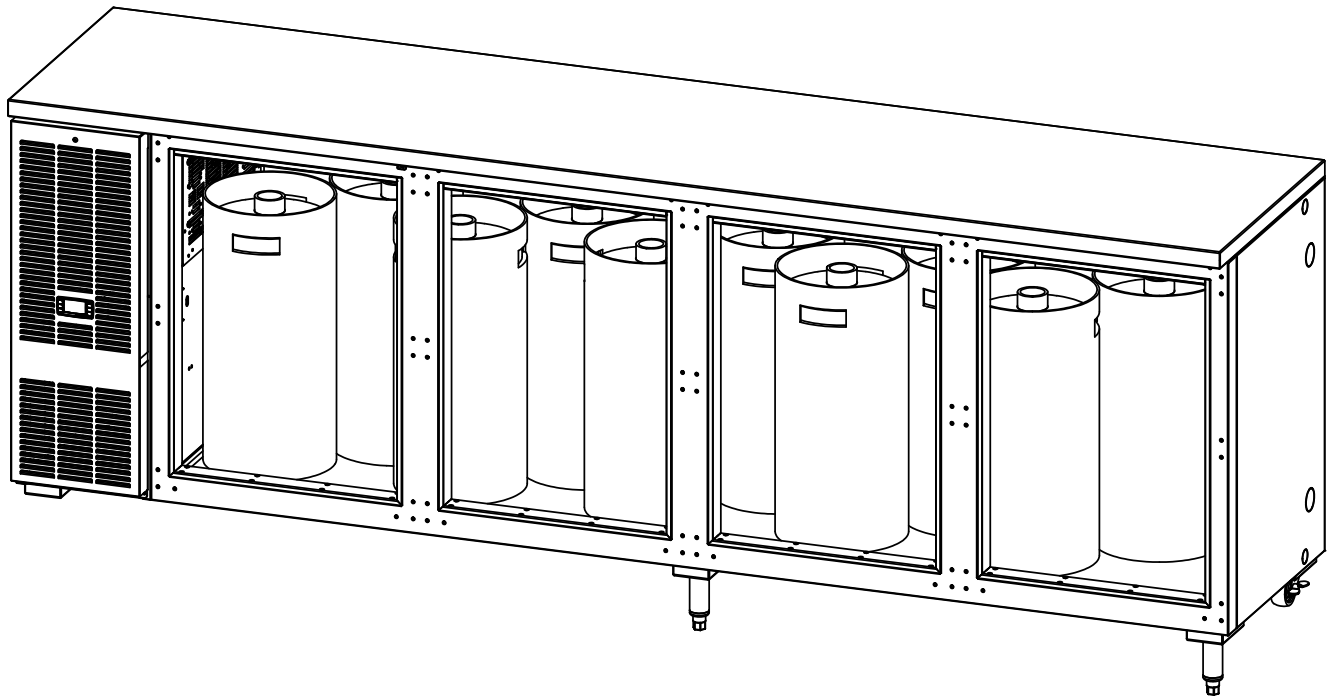

- NOTES:
- 1. KEG CAPACITY DIAGRAM IS SHOW FOR MAXIMUM CABINET SPACE ONLY. CUSTOMER TO DETERMINE OPTIMUM PLACEMENT OF DIFFERENT KEG SIZES.
  - 2. 1/8" SPACING WAS USED BETWEEN KEGS AND INSIDE CABINET FOR KEG DIA TOLERACE AND FIT UP.
  - 3. REFERANCE ASSEMBLY # IS: BBS108



PERLICK CORPORATION  
MILWAUKEE, WI 53223

PROPERTY OF THE PERLICK CORP.  
NOT TO BE COPIED OR USED DETRIMENTAL TO OUR INTERESTS

SCALE:	1:16
DR.: TJZ	DATE: 5/14/13
95145	
SHEET 5 OF 12	

KEG CAPACITY OF STANDARD 4 DOOR CABINETS  
(19 SIXTH BARRELS)

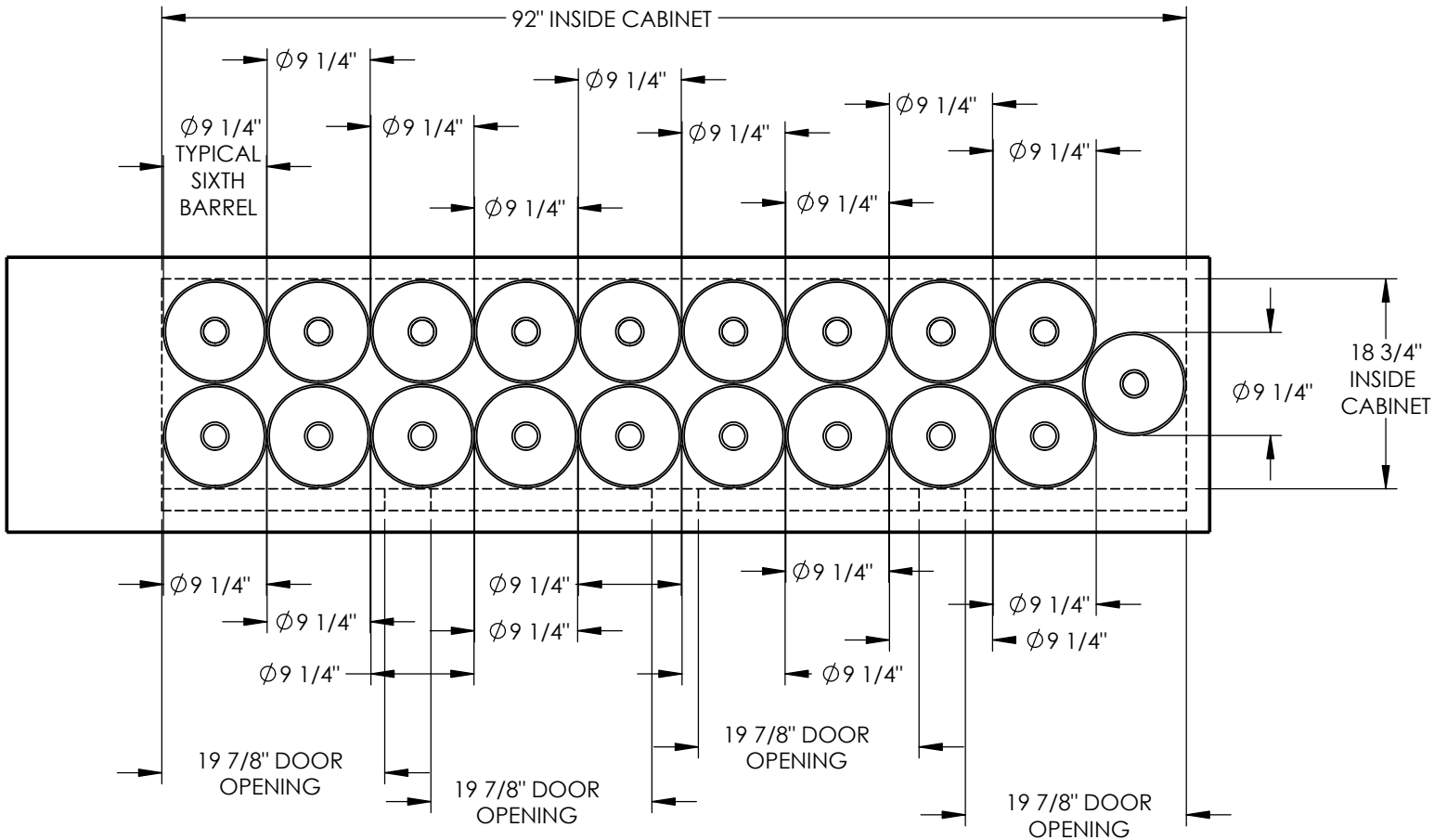
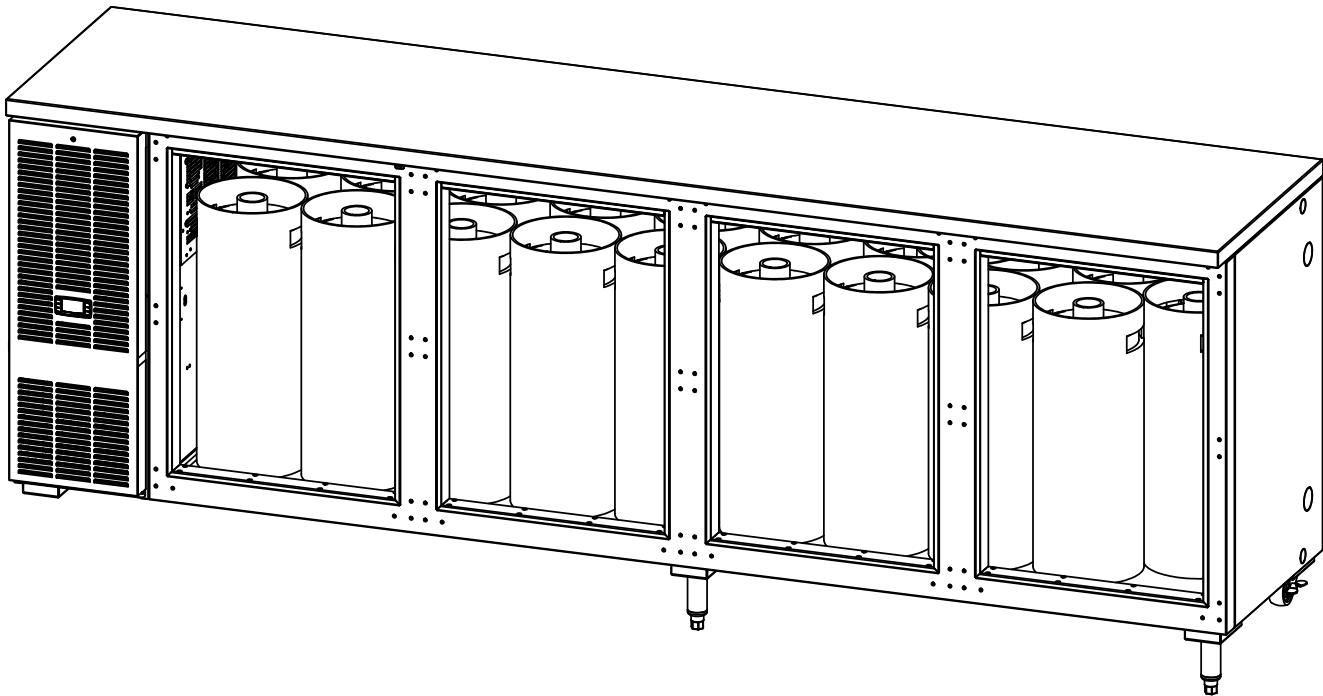

- NOTES:
- 1. KEG CAPACITY DIAGRAM IS SHOW FOR MAXIMUM CABINET SPACE ONLY. CUSTOMER TO DETERMINE OPTIMUM PLACEMENT OF DIFFERENT KEG SIZES.
  - 2. 1/16" SPACING WAS USED BETWEEN KEGS AND INSIDE CABINET FOR KEG DIA TOLERACE AND BEST FIT UP.
  - 3. REFERENCE ASSEMBLY # IS: BBS108



PERLICK CORPORATION  
MILWAUKEE, WI 53223

PROPERTY OF THE PERLICK CORP.  
NOT TO BE COPIED OR USED DETRIMENTAL TO OUR INTERESTS

SCALE:	1:16
DR.: TJZ	DATE: 5/14/13
95145	
SHEET 6 OF 12	



KEG CAPACITY OF STANDARD 4 DOOR CABINETS  
(5 HALF BARRELS, 2 SIXTH BARRELS)

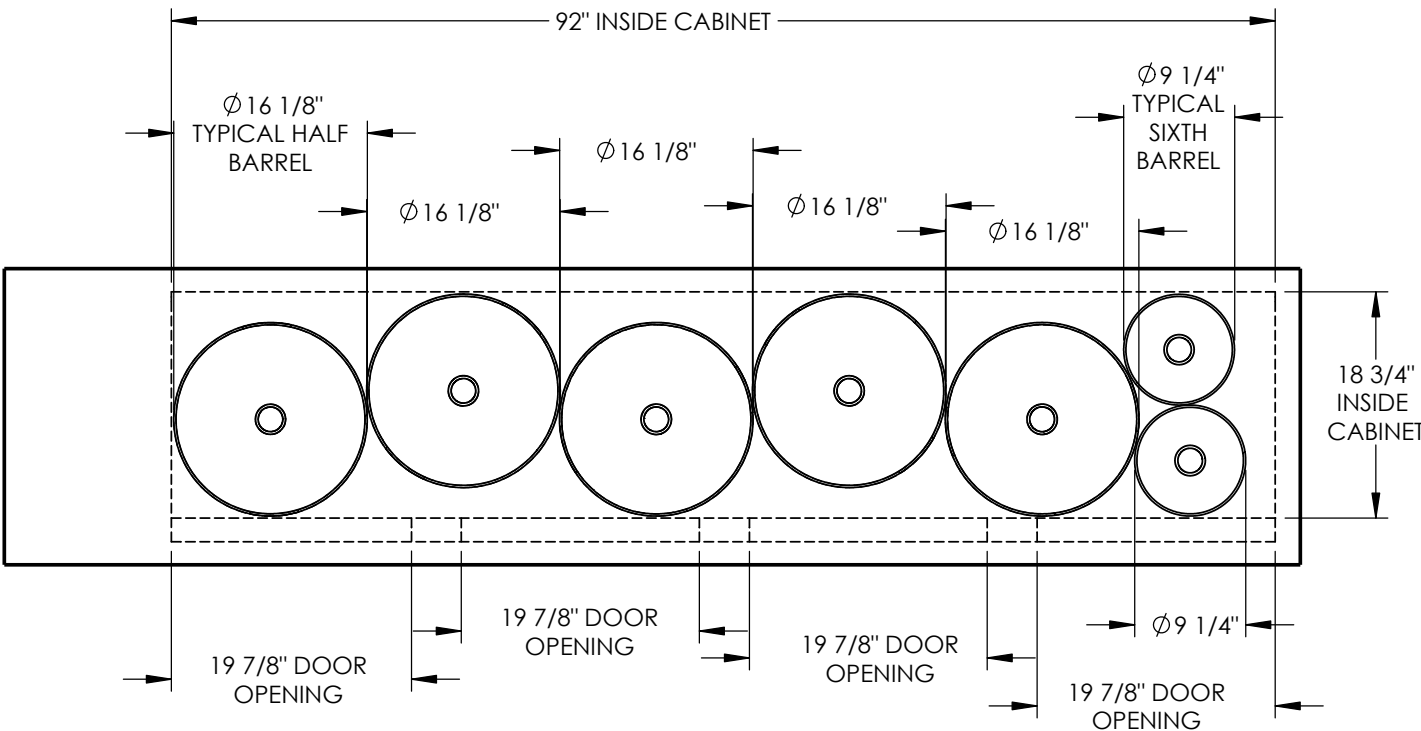
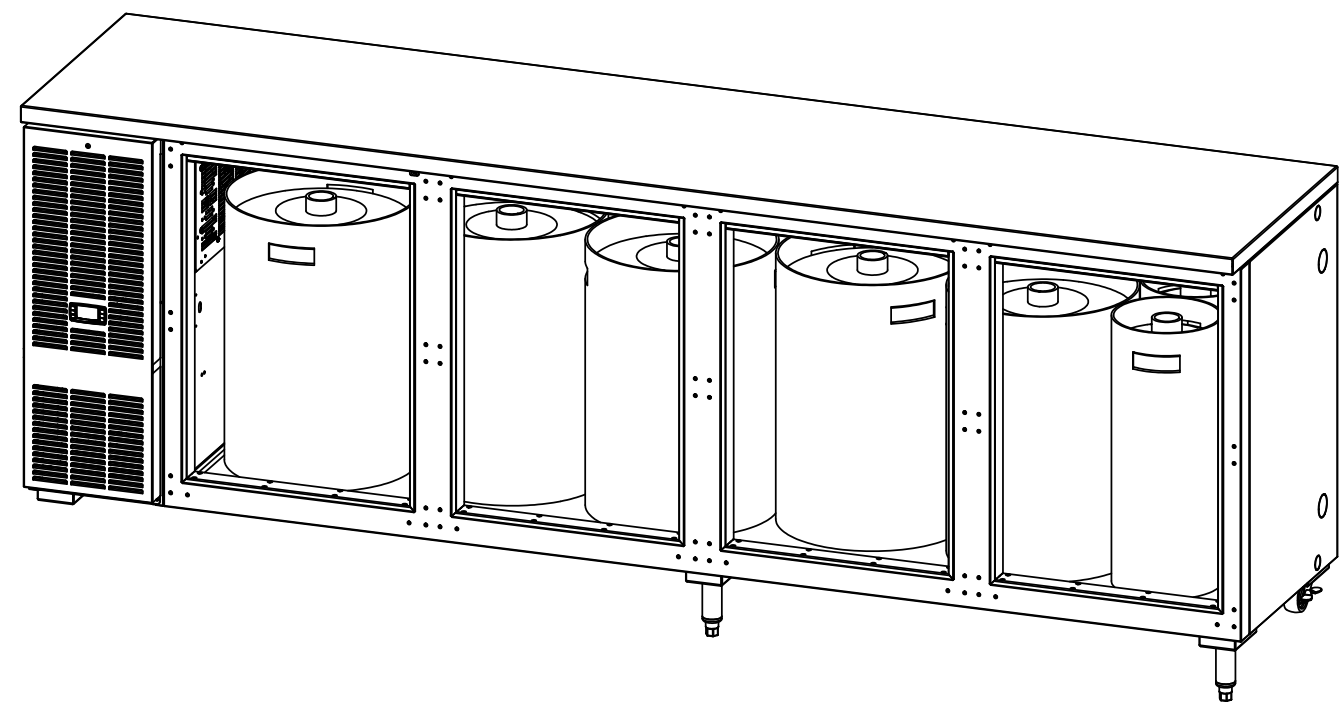

- NOTES:
- 1. KEG CAPACITY DIAGRAM IS SHOW FOR MAXIMUM CABINET SPACE ONLY. CUSTOMER TO DETERMINE OPTIMUM PLACEMENT OF DIFFERENT KEG SIZES.
  - 2. 1/8" SPACING WAS USED BETWEEN KEGS AND INSIDE CABINET FOR KEG DIA TOLERACE AND FIT UP.
  - 3. REFERANCE ASSEMBLY # IS: BBS108



PERLICK CORPORATION  
MILWAUKEE, WI 53223

PROPERTY OF THE PERLICK CORP.  
NOT TO BE COPIED OR USED DETRIMENTAL TO OUR INTERESTS

SCALE:	1:16
DR.: TJZ	DATE: 5/14/13
95145	
SHEET 7 OF 12	

PRINTED  
5/22/2013

# KEG CAPACITY OF STANDARD 4 DOOR CABINETS (4 HALF BARRELS, 1 SLIM QUARTER BARREL, 3 SIXTH BARRELS)

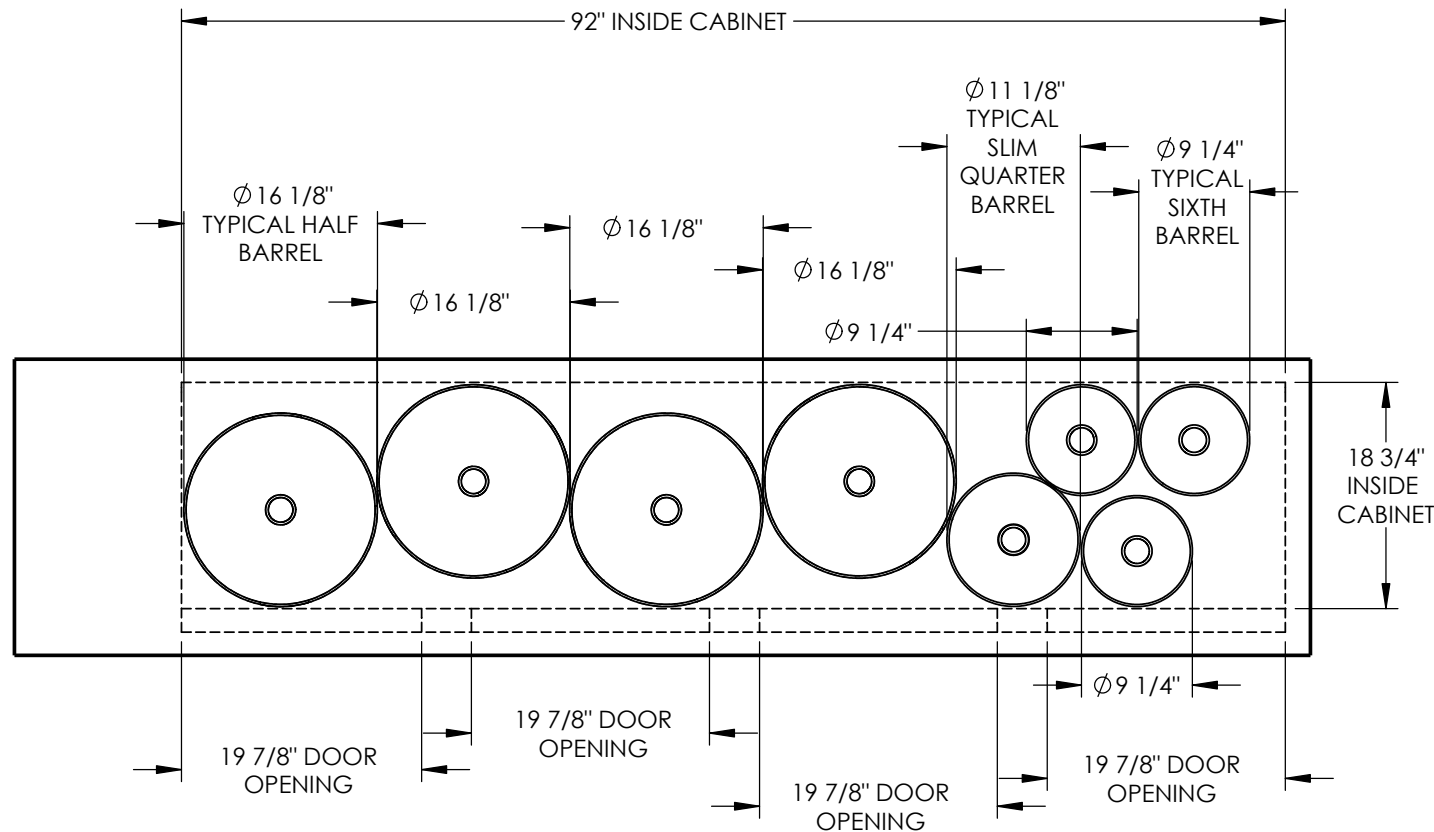
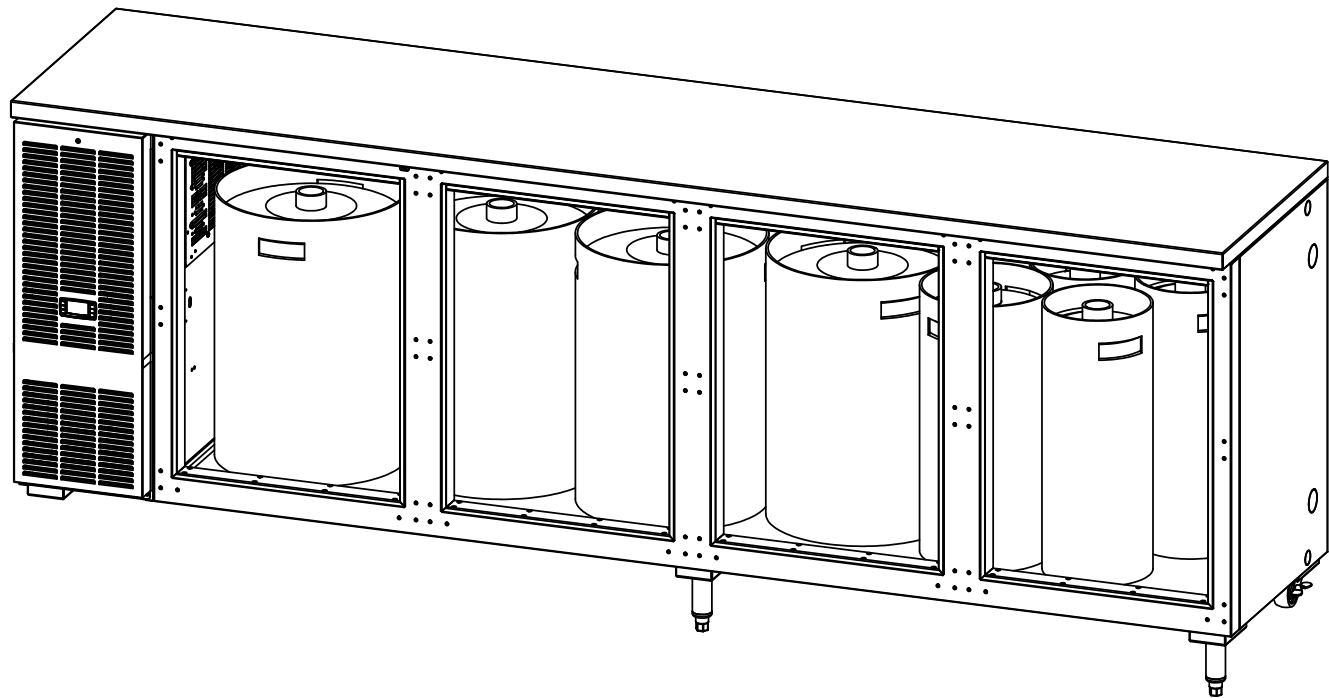

- NOTES:
- 1. KEG CAPACITY DIAGRAM IS SHOW FOR MAXIMUM CABINET SPACE ONLY. CUSTOMER TO DETERMINE OPTIMUM PLACEMENT OF DIFFERENT KEG SIZES.
  - 2. 1/8" SPACING WAS USED BETWEEN KEGS AND INSIDE CABINET FOR KEG DIA TOLERACE AND FIT UP.
  - 3. REFERENCE ASSEMBLY # IS: BBS108



PERLICK CORPORATION  
MILWAUKEE, WI 53223

PROPERTY OF THE PERLICK CORP.  
NOT TO BE COPIED OR USED DETRIMENTAL TO OUR INTERESTS

SCALE:	1:16
DR.: TJZ	DATE: 5/14/13
95145	
SHEET 8 OF 12	

PRINTED  
5/22/2013



# KEG CAPACITY OF STANDARD 4 DOOR CABINETS (4 HALF BARRELS, 6 SIXTH BARRELS)

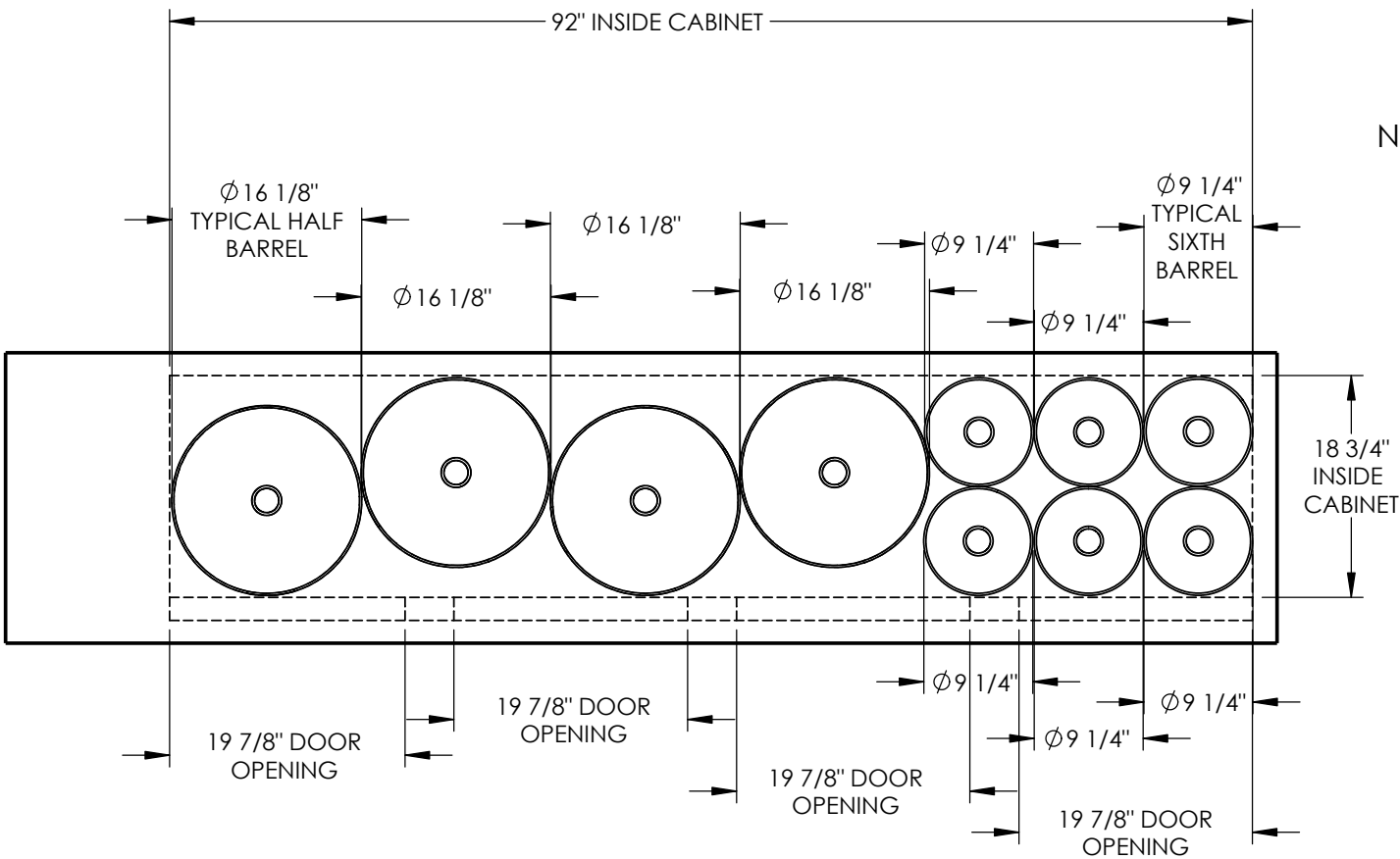
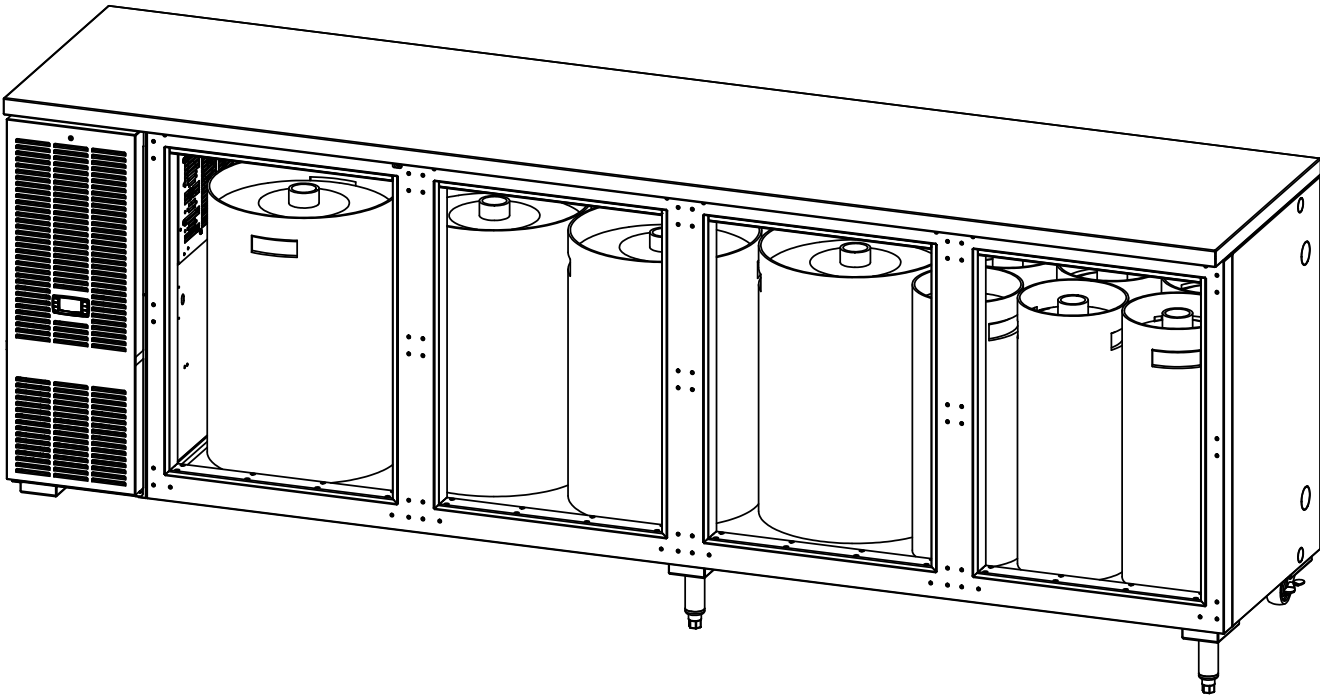

- NOTES:
1. KEG CAPACITY DIAGRAM IS SHOW FOR MAXIMUM CABINET SPACE ONLY. CUSTOMER TO DETERMINE OPTIMUM PLACEMENT OF DIFFERENT KEG SIZES.
  2. 1/8" SPACING WAS USED BETWEEN KEGS AND INSIDE CABINET FOR KEG DIA TOLERACE AND FIT UP.
  3. REFERANCE ASSEMBLY # IS: BBS108



PERLICK CORPORATION  
MILWAUKEE, WI 53223

PROPERTY OF THE PERLICK CORP.  
NOT TO BE COPIED OR USED DETRIMENTAL TO OUR INTERESTS

SCALE: 1:16  
DR.: TJZ DATE: 5/14/13

PRINTED  
5/22/2013

95145  
SHEET 9 OF 12

## A perspective line drawing of a long, low-profile industrial machine, possibly a medical device or a specialized storage unit. The machine has a flat top and a front panel that is partially removed, revealing four large, vertical cylindrical components arranged in a row. Each cylinder has a small rectangular label near its base. The machine is supported by four legs, and a cable is visible on the right side. The drawing is a technical illustration with clean lines and no shading.

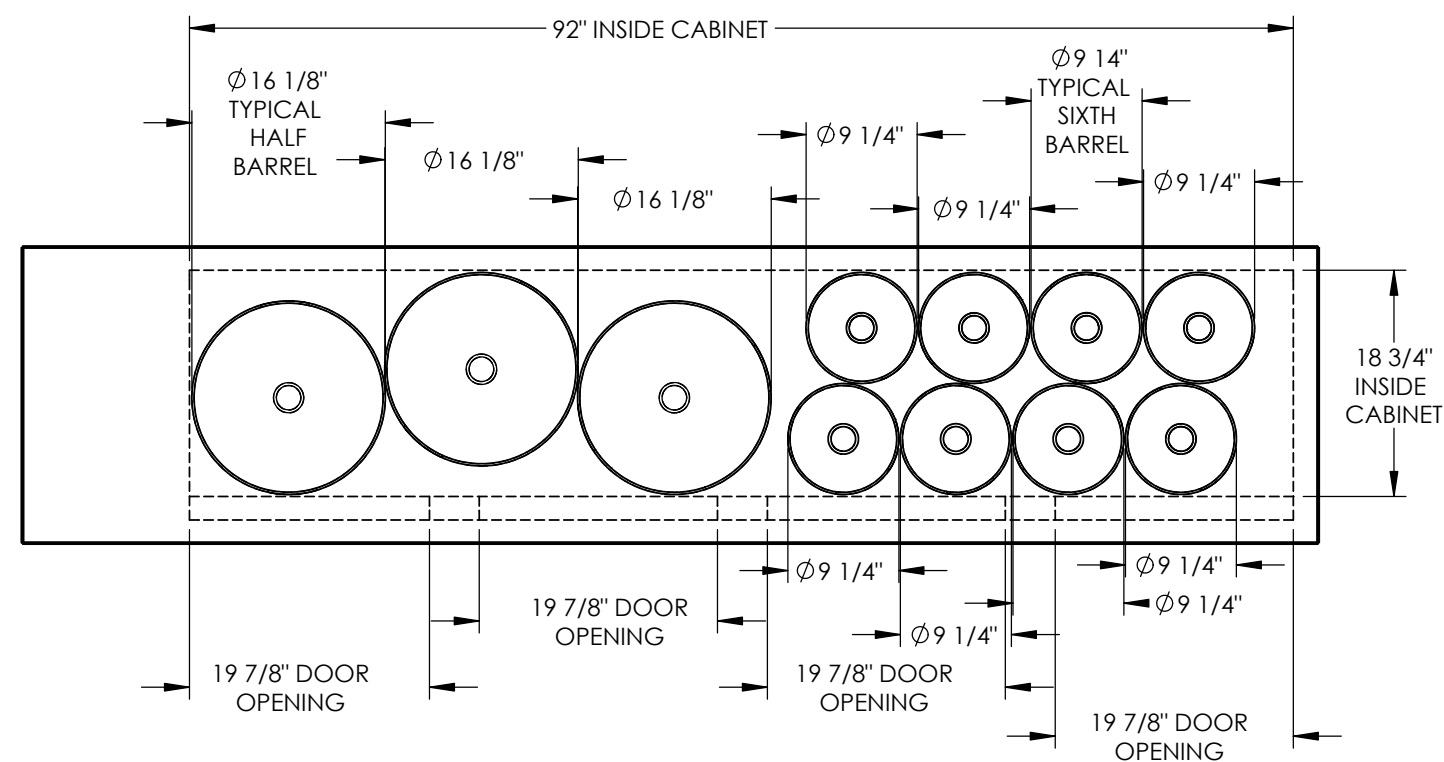

1. KEG CAPACITY DIAGRAM IS SHOW FOR MAXIMUM CABINET SPACE ONLY. CUSTOMER TO DETERMINE OPTIMUM PLACEMENT OF DIFFERENT KEG SIZES.
2. 1/8" SPACING WAS USED BETWEEN KEGS AND INSIDE CABINET FOR KEG DIA TOLERANCE AND FIT UP.
3. REFERENCE ASSEMBLY # IS: BBS108

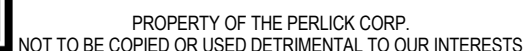

SHEET 10 OF 12

PRINTED  
5/22/2013

# KEG CAPACITY OF STANDARD 4 DOOR CABINETS (2 HALF BARRELS, 12 SIXTH BARRELS)

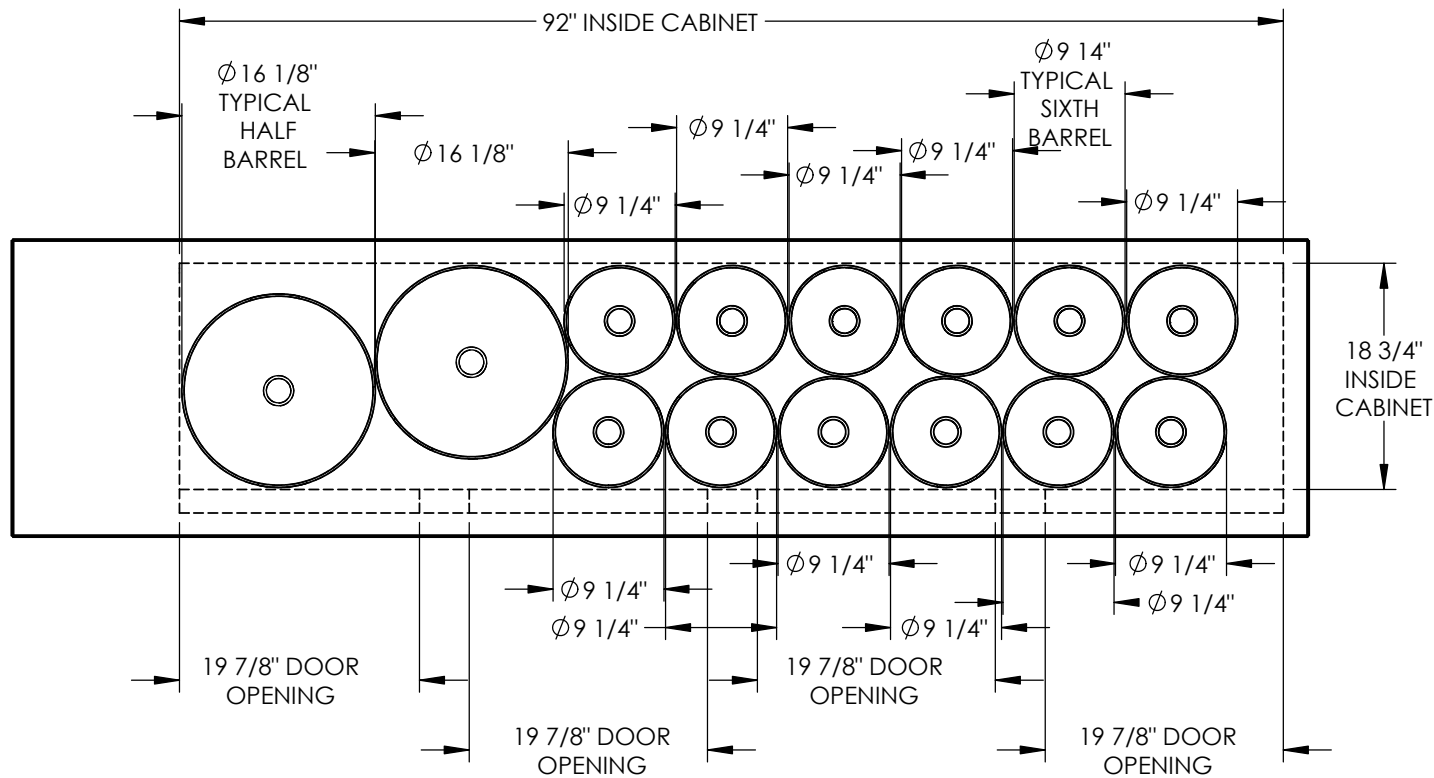
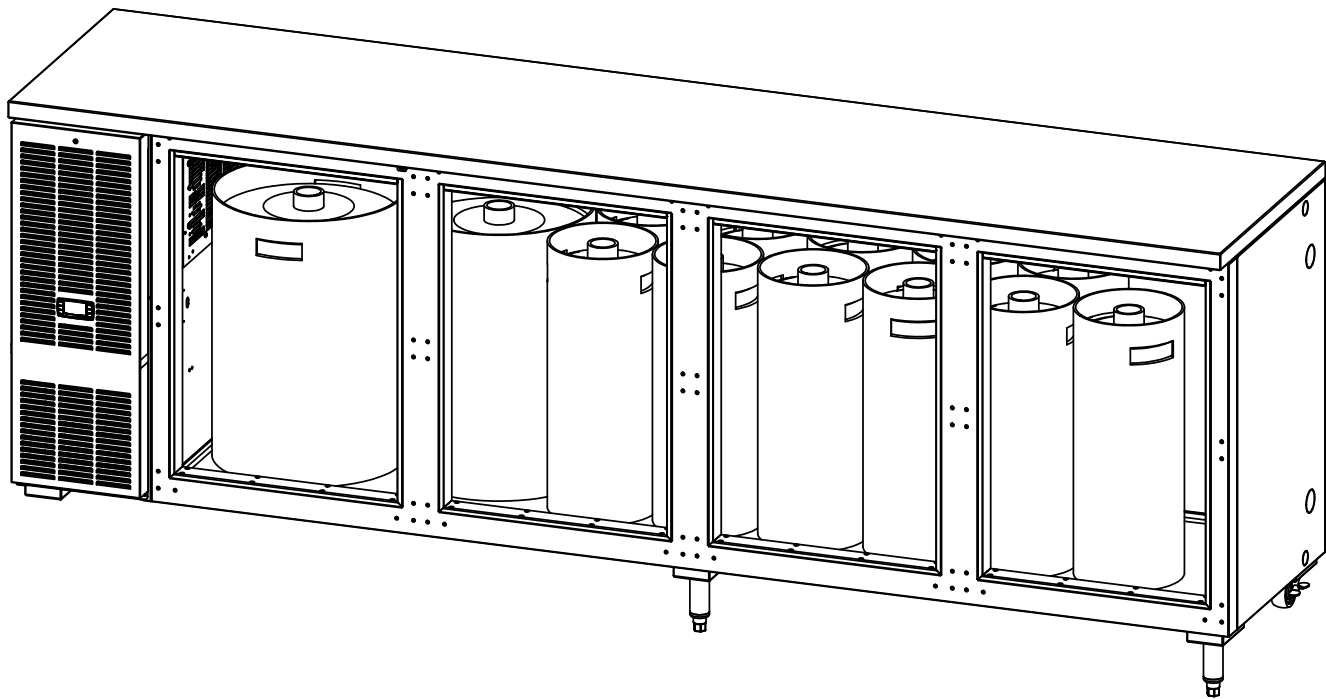

- NOTES:
1. KEG CAPACITY DIAGRAM IS SHOW FOR MAXIMUM CABINET SPACE ONLY. CUSTOMER TO DETERMINE OPTIMUM PLACEMENT OF DIFFERENT KEG SIZES.
  2. 1/8" SPACING WAS USED BETWEEN KEGS AND INSIDE CABINET FOR KEG DIA TOLERACE AND FIT UP.
  3. REFERANCE ASSEMBLY # IS: BBS108



PERLICK CORPORATION  
MILWAUKEE, WI 53223

PROPERTY OF THE PERLICK CORP.  
NOT TO BE COPIED OR USED DETRIMENTAL TO OUR INTERESTS

SCALE:	1:16
DR.: TJZ	DATE: 5/14/13
95145	
SHEET 11 OF 12	

PRINTED  
5/22/2013

# KEG CAPACITY OF STANDARD 4 DOOR CABINETS (1 HALF BARRELS, 15 SIXTH BARRELS)

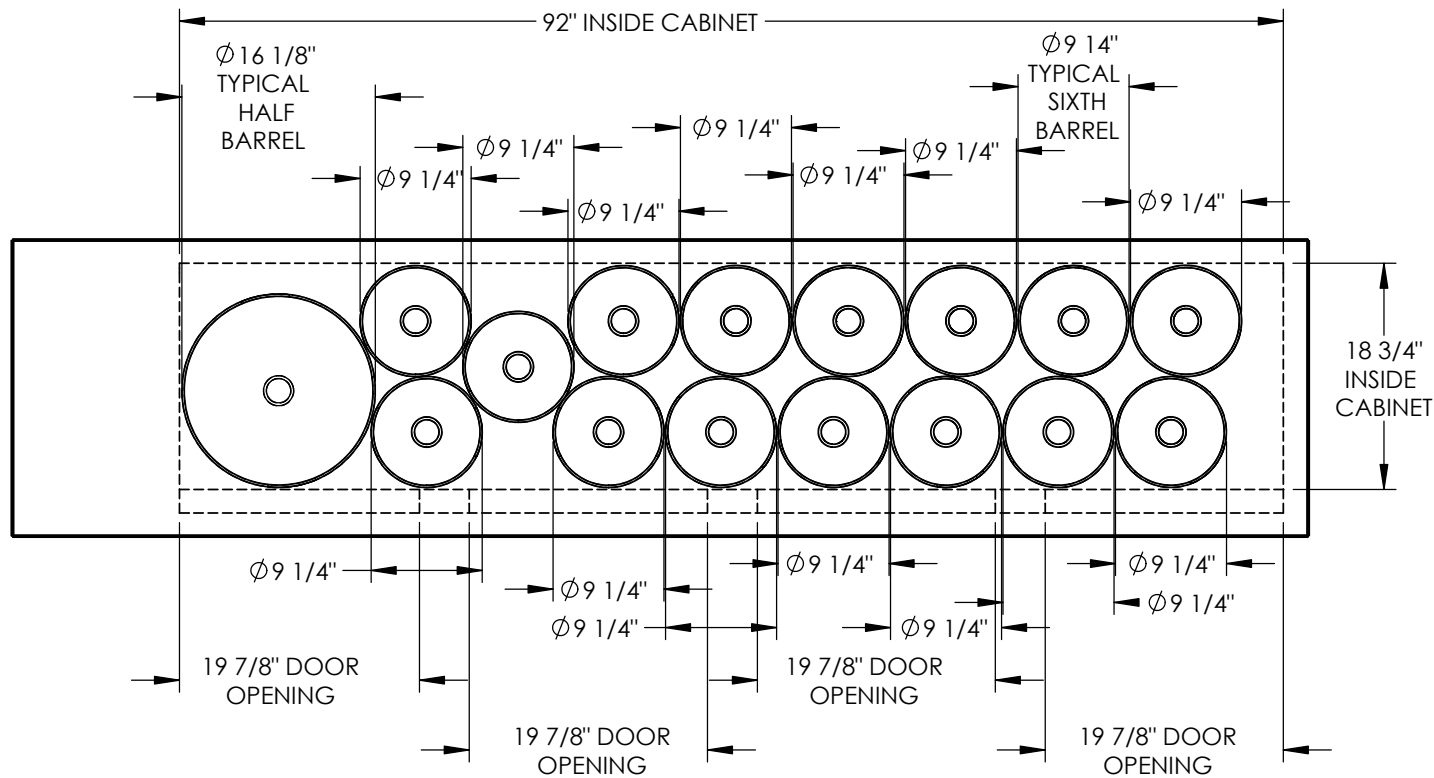
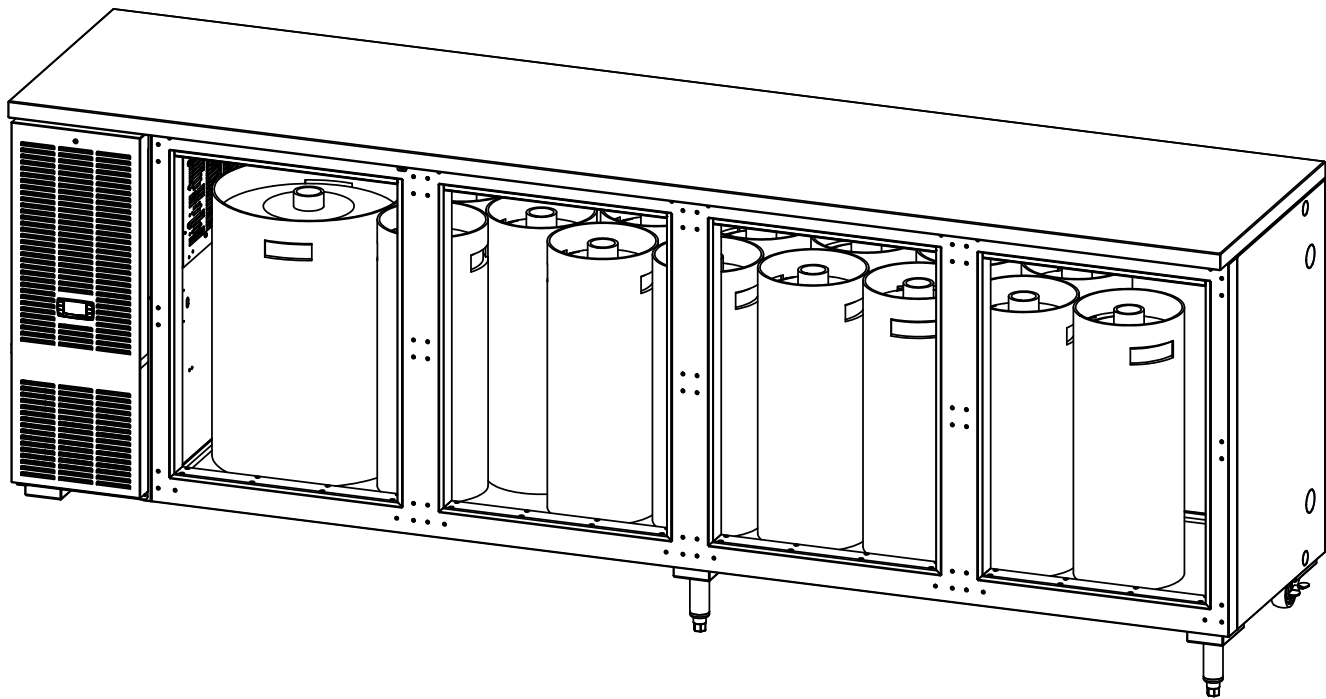

- NOTES:
1. KEG CAPACITY DIAGRAM IS SHOW FOR MAXIMUM CABINET SPACE ONLY. CUSTOMER TO DETERMINE OPTIMUM PLACEMENT OF DIFFERENT KEG SIZES.
  2. 1/8" SPACING WAS USED BETWEEN KEGS AND INSIDE CABINET FOR KEG DIA TOLERACE AND FIT UP.
  3. REFERANCE ASSEMBLY # IS: BBS108



PERLICK CORPORATION  
MILWAUKEE, WI 53223

PROPERTY OF THE PERLICK CORP.  
NOT TO BE COPIED OR USED DETRIMENTAL TO OUR INTERESTS

SCALE:	1:16
DR.: TJZ	DATE: 5/14/13
95145	
SHEET 12 OF 12	

PRINTED  
5/22/2013